



Click Here To View
Item at

www.GapPower.com

*Sales • Rentals
Parts & Service*

Complete Hydraulic unit

Parts 152
Came here
from the
factory

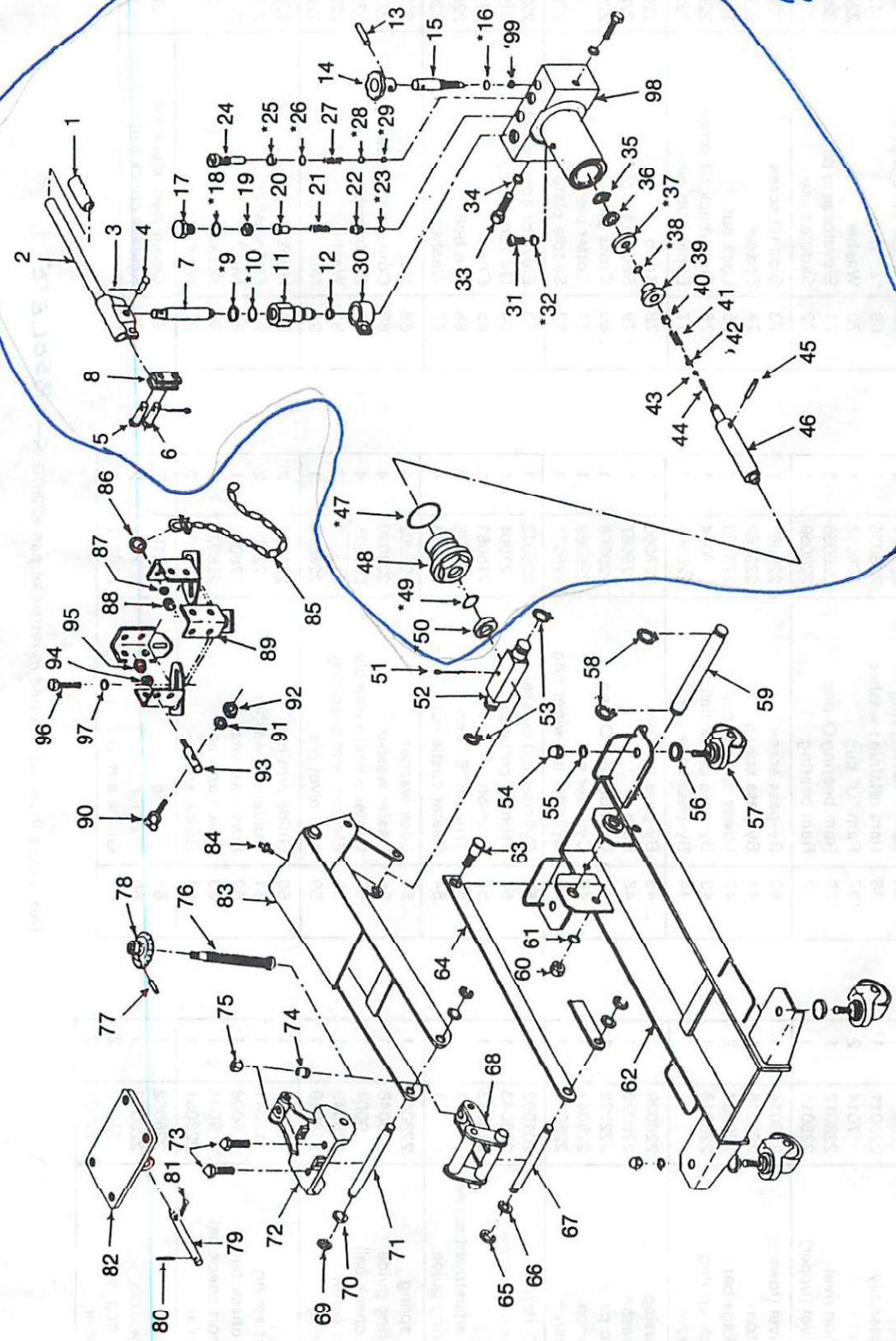

228700 ~~absolute~~

*Designates those parts found in repair kit part #227600.

NORCO

DESCRIPTION
HYDRAULIC TRANSMISSION JACK

CAPACITY
1/2 TON

MODEL NO.
72C50B

REPLACEMENT
PARTS

INDEX NO.	DESCRIPTION	PART NO.	QTY.
1	Handle grip	228001	1
2	Handle assembly	228011	1
3	Cotter pin	7014	2
4	Pump piston rivet	228012	1
5	Linkage rivet (upper)	228013	1
6	Linkage rivet (lower)	228014	1
*7	Pump piston	228016	1
8	Pump linkage bar	228107	2
*9	Pump back-up ring	228018	1
*10	Pump O-ring	1	1
11	Pump housing	228039	1
12	Copper washer	228022	1
13	Expansion pin	222228	1
14	Release knob	228041	1
15	Release valve	228042	1
*16	Release O-ring	201092	1
17	Overload cover screw	228043	1
*18	O-ring	218012	1
19	Overload adjustment screw	1	1
20	Upper spring guide	1	1
21	Overload spring	228047	1
22	Lower spring guide	228048	1
*23	Overload check ball	9004	1
24	Valve port screw	228049	1
*25	Back-up ring	218019	1
*26	O-ring	218021	1
27	Valve port spring	218041	1
*28	Injection check ball	9008	1
*29	Suction port check ball	9004	1
30	Swivel collar	228051	1
31	Oil fill plug	228052	1
*32	Fill plug washer	228053	1
33	Oil block mtg. screw	31003	2
34	Lock washer	22002	2

72050B

INDEX NO.	DESCRIPTION	PART NO.	QTY.
35	Ram retaining ring	228054	1
36	Ram retaining washer	228056	1
*37	Ram "U" cup	228057	1
*38	Ram bearing O-ring	228058	1
39	Ram bearing	228059	1
40	By-pass screw	228061	1
41	By-pass spring	228062	1
42	Lower spring adapter	228063	1
43	By-pass check ball	9004	1
44	By-pass valve pin	228064	1
45	By-pass limit pin	228066	1
46	Ram	228067	1
*47	Cylinder nut O-ring	228068	1
48	Cylinder nut	228069	1
*49	Cylinder nut wiper ring	228071	1
*50	Cylinder nut oil seal	228072	1
51	Trunion cotter pin	27004	1
52	Trunion	215063	1
53	Trunion "E" ring	215076	2
54	Caster castle nut	228073	4
55	Lock washer	22002	4
56	Caster washer	228026	4
57	Caster wheel assembly	228075	4
58	Elevator arm snap ring	215073	2
59	Arm pivot pin	228074	1
60	Guide arm nut	228076	2
61	Guide arm washer	22004	2
62	Frame assembly	228080	1
63	Guide arm bolt	228077	2
64	Guide arm	228031	2
65	"E" ring	12121	2
66	Washer	2068	2
67	Guide arm pin	228032	1

INDEX NO.	DESCRIPTION	PART NO.	QTY.
68	Saddle base support	228085	1
69	"E" ring	12121	2
70	Washer	228033	2
71	Elevator arm pin	228034	2
72	Saddle base	228090	1
73	Side tilt screw	228078	2
74	Spacer	228036	1
75	Lock nut	228079	1
76	Front/back tilt screw	228081	1
77	Expansion pin	222228	1
78	Knob	228082	1
79	Saddle tilt pin	228233	1
80	Cross pin	228037	1
81	Cotter pin	7021	1
82	Saddle plate	228070	1
83	Elevator arm assembly	228040	1
84	Oil zerk fitting	215122	1
85	Chain	282067	2
86	Eye bolt	228083	2
87	Washer	228084	2
88	Nut	228086	2
89	Containing angle	228231	4
90	Chain hook	228093	2
91	Washer	228087	2
92	Nut	228088	2
93	Hook guide	228089	2
94	Flat washer	228091	2
95	Nut	228092	2
96	Screw	3072	4
97	Washer	2017	4
98	Comp. hyd. block assy.	228300	1
*99	Release check ball	9004	1

*Designates those parts found in repair kit part #228700. ← o BSOLETC