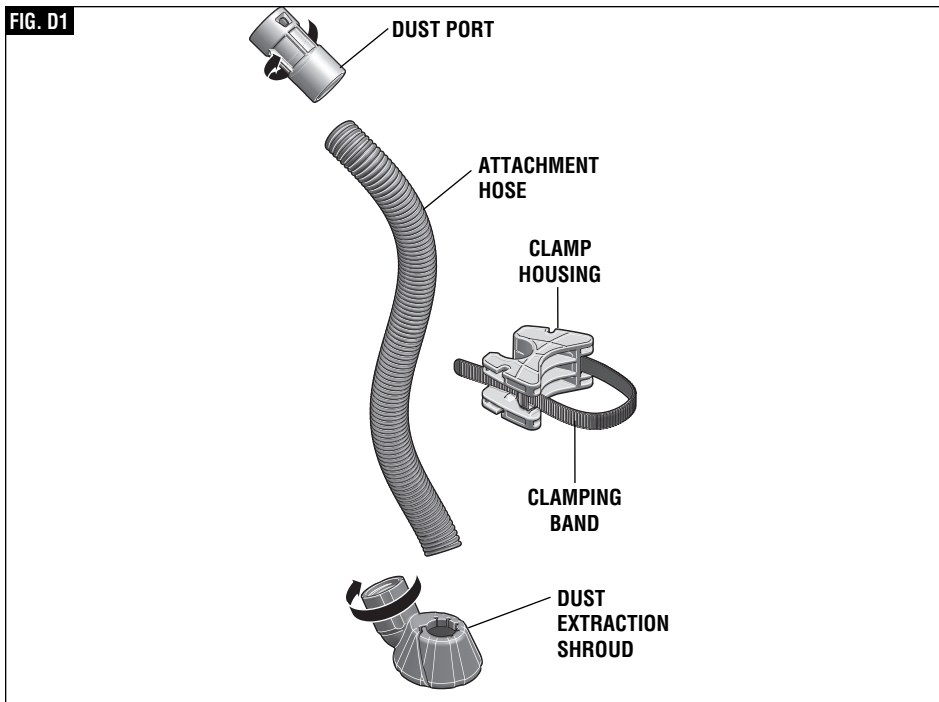

HDC400**Functional Description and Specifications**

⚠ WARNING To reduce the risk of injury user must read instruction manual for the use of the tool with this attachment.

SAVE THESE INSTRUCTIONS

**HDC400****Assembly**

⚠ WARNING Disconnect the plug from the power source before making any assembly, adjustments or changing accessories. Such preventive safety measures reduce the risk of starting the tool accidentally.

Note: make sure the desired chisel is installed on the hammer before assembling the dust collection attachment.

Open fully the clamping band lever on the clamp housing. Push the release lever and pull the clamping band out. See figure D2. Position the attachment on the hammer tube of the tool, wrap the clamping band around

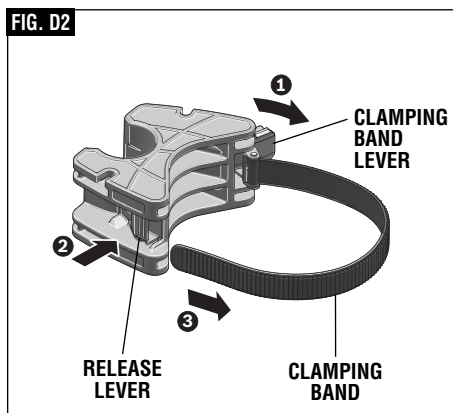

HDC400**Assembly**

the hammer tube and insert it back into the release lever. The clamping band should be resting loosely on the hammer tube. Then close the clamping band lever to secure the attachment on the tool. Test to ensure no slippage (Fig. D3, D4). If necessary, you may have to tighten or loosen the band in the release lever to achieve the most secure fit.

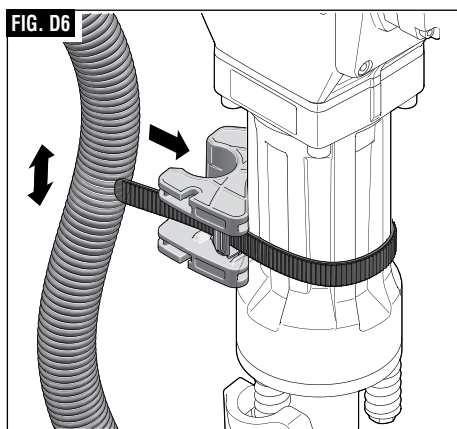
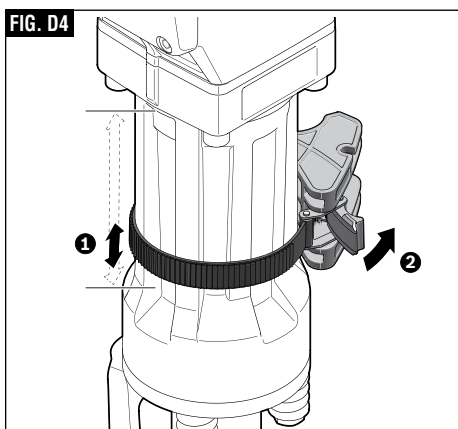
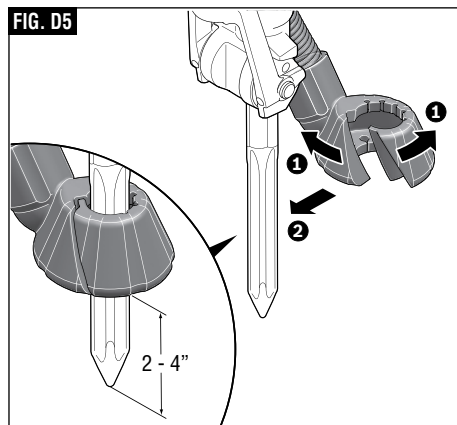
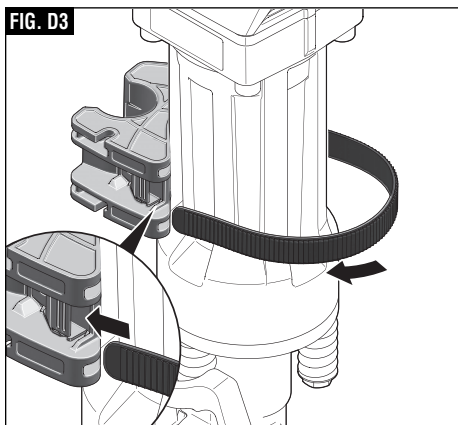

Insert the dust extraction shroud on the 1-1/8" hex chisel (Fig. D5). For optimum dust collection results, the shroud should be positioned within 2" – 4" from the chisel tip. Insert the attachment hose into the clamp housing (Fig. D6). Note: there should be little or no slack of the hose between the clamp housing and the shroud.

HDC400**Operating instructions**

Chiseling only: The HDC400 is designed to be used for chiseling/demolition of concrete and masonry materials with 1-1/8" hex chisels.

The dust extraction attachment should be positioned approximately 2-4" from the tip of the bit for best dust extraction results (Fig. D5). You can adjust the positioning of the attachment by opening the clamping band lever and sliding the attachment up or down

on the hammer tube. When complete close the clamping band lever to re-secure the attachment to the tool (Fig. D4)

For extending the adjustment, the hose can also be moved up or down within the clamp housing. Remove the hose from the housing, position the hose so that the shroud is positioned for optimum dust collection, then insert the hose back into the clamp housing (Fig. D6).

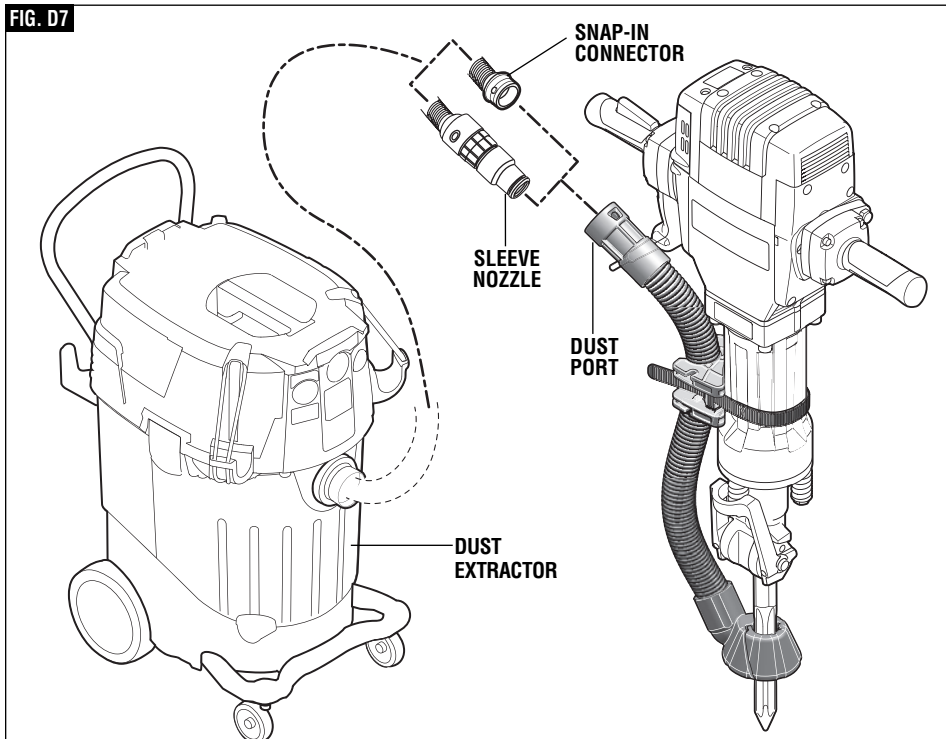
FIG. D7

Insert the dust extractor from the dust extractor into the dust hose of the dust extraction unit (Fig. D7).

The Bosch dust extractor hose comes with a sleeve nozzle attached to a snap-in connector (Fig. D7). The sleeve nozzle provides the quickest, easiest connection of the nozzle to the attachment. The snap-in connector provides a more secured connection.

To use the snap-in connector, remove the rubber nozzle from the dust extractor hose.

Press the snap-in connector into the dust port until you hear the click.

Dust port adaptors are also available to connect the Bosch dust extraction attachment to any common size dust extractor hose. See Boschtools.com for details.

Turn the dust extractor on and place the tool / attachment over the desired chiseling location. Follow all tool safety and operating instructions.

Tool Tips

DRILLING WOOD OR PLASTIC

Do not drill into wood with dust extraction system mounted. Wood chips are typically too large and will clog the dust channel.

CAUTION If backing block is not used, ease up on the pressure just before the bit breaks through the wood to avoid splintering. Complete the hole from the opposite side immediately after the point breaks through. If bit binds, reverse the drilling operation to help remove the bit from the work.

DRILLING METAL

WARNING Do not drill into metal with the dust extraction system mounted. Hot metal chips can self-ignite or ignite parts of the dust extraction system.

Maintenance

Service

WARNING Preventive maintenance performed by unauthorized personnel may result in misplacing of internal wires and components which could cause serious hazard. We recommend that all tool service be performed by a Bosch Factory Service Center or Authorized Bosch Service Station.

Cleaning

WARNING To avoid accidents always disconnect the tool from the power supply before cleaning or performing any maintenance.

The tool may be cleaned most effectively with compressed dry air. **Always wear safety goggles when cleaning tools with compressed air.**

Ventilation openings and switch levers must be kept clean and free of foreign matter. Do not attempt to clean by inserting pointed objects through openings.

CAUTION Certain cleaning agents and solvents damage plastic parts. Some of these are: gasoline, carbon tetrachloride, chlorinated cleaning solvents, ammonia and household detergents that contain ammonia.