



Click Here To View
Item at

www.GapPower.com

*Sales • Rentals
Parts & Service*

STIHL

Search

Go

| E-mail | Site Map |
En Español

Dealer Locator



Products

New
Chain Saws
Accessories
Augers / Drills
Blowers / Sprayers
Construction Tools
Edgers
Hand Tools
Hedge Trimmers
Pole Pruners
Multi-Task Tools
Protective Apparel
Trimmers /
Brushcutters
Oil and Lubricants
Saw Chain / Guide
Bars



What's New



Press Office



Information



Corporate



Employment



Events



FAQ



Newsletter



Contact Us

STIHL HT 101 Telescoping Pole Pruner

Professional User



POLE PRUNER MODELS:

Select Model Below

HT 101 Telescoping Pole Pruner

DISPLACEMENT	31.4 cc (1.9 cu. in.)
ENGINE POWER	1.05 kW (1.4 bhp)
WEIGHT (WITH CUTTING ATTACHMENT)	7.4 kg (16.3 lbs.)
FUEL CAPACITY	530 cc (18.0 oz.)
CHAIN OIL CAPACITY	220 cc (7.4 oz.)
OILOMATIC® CHAIN	3/8" PMMC3 12" Bar and Chain
SHAFT LENGTH	7'6" to 11'6"

**Shaft adjusts from 7'6" to 11'6",
allowing the user to reach branches
up to 16' above ground.**

Check Pricing

Enter Zip Code
 **Check Price and Reserve
Products Online**
 Show All Local Dealers

Don't let cutting those tough branches get the best of you. For those hard-to-get-to trees, the HT 101 STIHL telescoping pole pruner will take you there. Powered by a low-emission engine, its shaft adjusts from 7 ft. 6 in. to 11 ft. 6 in. — allowing professionals to reach branches up to 16 ft. above the ground.

Standard Features

- Powered by a [proven low-emission engine](#)
- Telescoping-shaft pole pruner
- Automatic bar and chain oiler
- Side-access chain tensioner
- 12" PMMC3 STIHL bar and chain
- [View standard features common to all STIHL pole pruners](#)

Optional Accessories

- Basket-style carry harness
- HT carrier support system



[Pole Pruner Features](#)

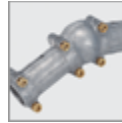

[Pole Pruner Accessories](#)



[Comparison Chart](#)



[STIHL Limited Warranty](#)

IMPORTANT INFORMATION

Danger! Risk of Electrocutation

Pole pruners are not insulated. Approaching or contacting electric power lines with these tools may cause serious injury or death from electrocution. Electricity can jump from one point to another by means of arcing and/or may be conducted through damp branches. Maintain a clearance of at least 50 feet (15 M) between the tools and any electrical line carrying a live current. To reduce the risk of injury from falling objects, do not cut vertically above your head. Always wear appropriate protective apparel as outlined in the instruction manual. Keep bystanders away. Use only STIHL authorized cutting attachments.

WARNING!

Improper use of any power tool may cause serious or fatal injury. Read, understand and follow carefully the operating and safety instruction in your instruction manual before using these products.

STIHL products sold through U.S. STIHL Dealers are for distribution in the United States only.

Follow STIHL USA on: [Facebook](#) [Twitter](#) [YouTube](#) [Blog](#)

[Home](#) | [Dealer Locator](#) | [Products](#) | [What's New](#) | [Press Office](#) | [Information](#) | [Corporate](#) | [Dealers Employment](#) | [Events](#) | [FAQ](#) | [Newsletter](#) | [Contact Us](#) | [Site Map](#) | [Mobile](#)
[Chain Saws](#) | [Trimmers](#) | [Blowers](#) | [Construction Tools](#) | [Edgers](#) | [Hedge Trimmers](#) | [Pole Pruners](#) | [Augers / Drills](#) | [Multi-Task Tools](#) | [Hand Tools](#) | [Accessories](#)
[Protective Apparel](#) | [Oil and Lubricants](#) | [Saw Chain / Guide Bars](#)

[Terms and Conditions](#) [Privacy Policy](#) [View trademarks owned by ANDREAS STIHL](#)

Copyright © 2011 STIHL Incorporated. All Rights Reserved.