

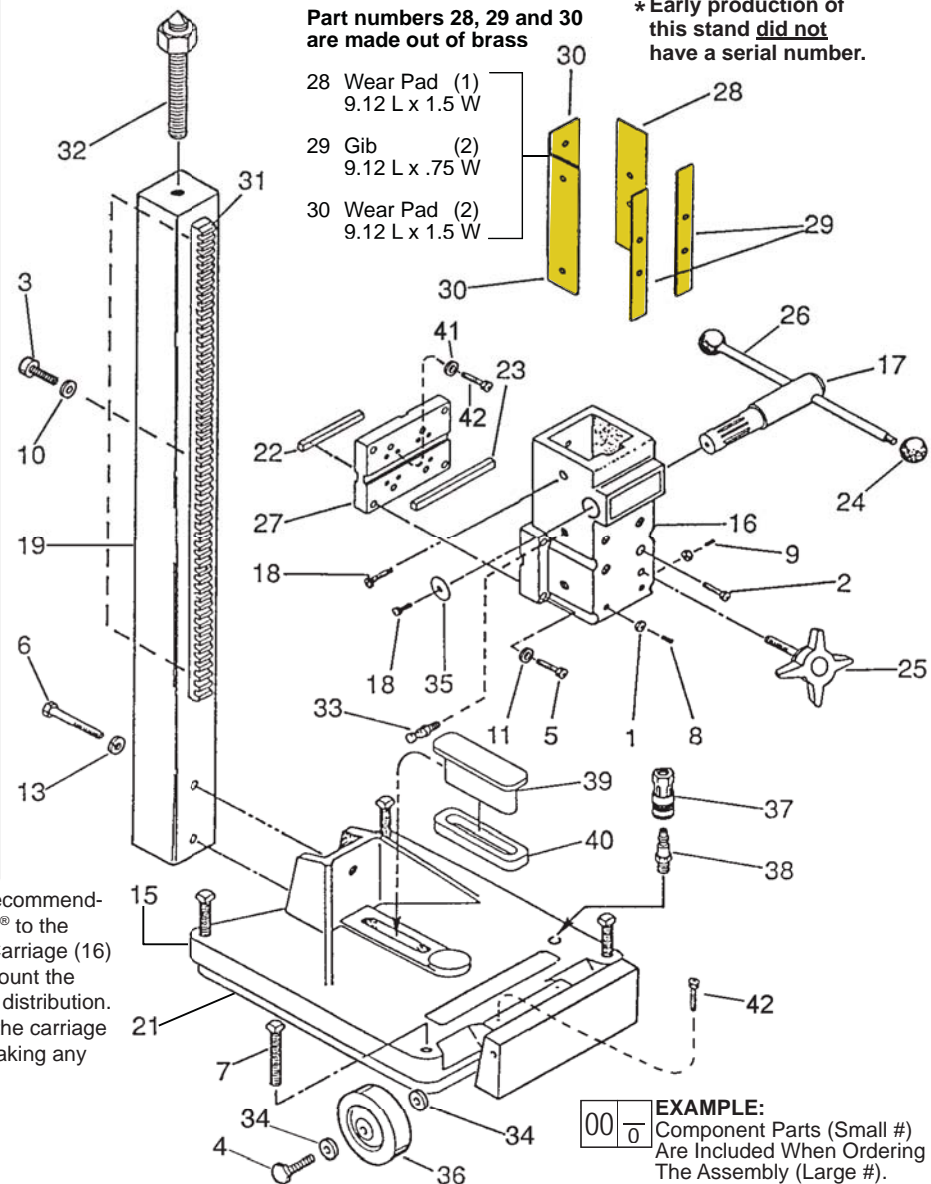

# SERVICE PARTS LIST

**BULLETIN NO.**  
**54-46-1375**

|   |             |                            |              |
|---|-------------|----------------------------|--------------|
| <b>SPECIFY CATALOG NO. AND SERIAL NO. WHEN ORDERING PARTS</b> |             | REVISED BULLETIN           | DATE         |
| <b>LARGE BASE DYMORIG</b>                                     |             |                            | July 2013    |
| <b>CATALOG NO.</b>  | <b>4120</b> | <b>STARTING SERIAL NO.</b> | <b>A09A*</b> |
|   |             | WIRING INSTRUCTION         |              |

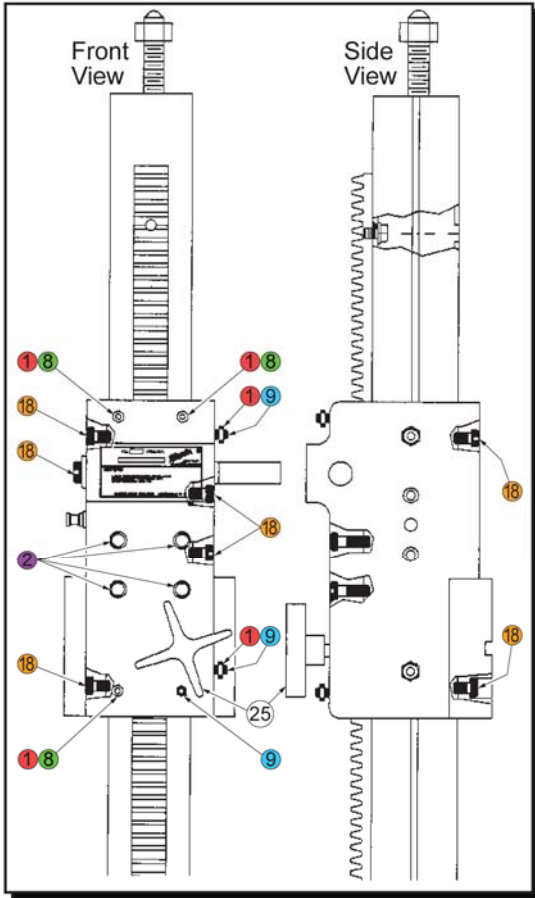

**Part numbers 28, 29 and 30 are made out of brass**

28 Wear Pad (1)  
9.12 L x 1.5 W

29 Gib (2)  
9.12 L x .75 W

30 Wear Pad (2)  
9.12 L x 1.5 W

\* Early production of this stand **did not** have a serial number.

To properly install Wear Pads and Gibs (28,29,30), it is recommended to clean Fasteners (2,8,9,18) and to apply Red Loctite® to the threads. Once the wear pads and gibs are in place, the Carriage (16) has to be adjusted to the Column (19). It is beneficial to mount the drill motor to the stand for proper carriage/column weight distribution. Carriage Screw (25) can be tightened slightly to prevent the carriage and drill motor from traveling down the column prior to making any screw adjustments.

**EXAMPLE:**  
Component Parts (Small #) Are Included When Ordering The Assembly (Large #).

| FIG. | PART NO.   | DESCRIPTION OF PART                | NO. REQ. |
|------|------------|------------------------------------|----------|
| 1    | 06-55-1525 | 1/4-20 Hex Nut                     | (5)      |
| 2    | 06-75-3050 | 1/4-20 x 3/4" Socket Hd. Screw     | (4)      |
| 3    | 06-75-3920 | 5/16-18 Socket Hd. Screw           | (3)      |
| 4    | 06-75-0970 | 1/2" Hex Hd. Cap Screw             | (2)      |
| 5    | 06-75-5840 | 3/8-16 Socket Hd. Cap Screw        | (4)      |
| 6    | 06-75-5845 | 5/8-11 Hex Hd. Cap Screw           | (2)      |
| 7    | 06-83-2100 | 5/8-11 x 3" Hex Hd. Cap Screw      | (4)      |
| 8    | 06-83-6010 | 1/4-20 x 1-1/2" Set Screw          | (3)      |
| 9    | 06-83-6020 | 1/4-20 x 1" Set Screw              | (3)      |
| 10   | 06-97-4110 | 5/16" Split Ring Lockwasher        | (3)      |
| 11   | 06-97-4127 | Lockwasher                         | (4)      |
| 13   | 06-97-4400 | 5/8" Split Ring Lockwasher         | (2)      |
| 14   | 12-99-1310 | Nameplate Blank                    | (1)      |
| 15   | 28-06-1090 | Large Base                         | (1)      |
| ★ 16 | 28-23-3415 | Carriage                           | (1)      |
| 17   | 36-66-4620 | Pinion Shaft                       | (1)      |
| 18   | 06-75-2950 | 1/4-20 x 1/2" Socket Hd. Cap Screw | (7)      |
| 19   | 42-78-0050 | Column                             | (1)      |
| 21   | 43-44-0605 | Base Gasket                        | (1)      |
| 22   | 43-96-0200 | 3/8 x 3/8 x 3" Key                 | (1)      |
| 23   | 43-96-0210 | 3/8 x 3/8 x 5" Key                 | (1)      |
| 24   | 43-98-0050 | Plastic Knob                       | (2)      |
| 25   | 43-98-0525 | Carriage Screw                     | (1)      |
| 26   | 44-10-0365 | Bar Handle                         | (1)      |
| 27   | 44-34-0190 | Motor Mount                        | (1)      |

| FIG. | PART NO.   | DESCRIPTION OF PART | NO. REQ. |
|------|------------|---------------------|----------|
| 28   | 44-52-0605 | Wear Pad            | (1)      |
| ★ 29 | 44-52-0665 | Gib                 | (2)      |
| ★ 30 | 44-52-0675 | Wear Pad            | (2)      |
| 31   | 44-80-0175 | Rack                | (1)      |
| 32   | 45-04-0535 | Jack Screw Assembly | (1)      |
| 33   | 45-58-0280 | Mounting Stud       | (1)      |
| 34   | 45-88-7460 | 1/2" Flat Washer    | (4)      |
| 35   | 45-88-8675 | Shaft Washer        | (1)      |
| 36   | 45-94-0135 | Wheel               | (2)      |
| 37   | 42-90-0125 | Female Coupling     | (1)      |
| 38   | 42-90-0115 | Male Coupling       | (1)      |
| 39   | 42-04-0466 | Vacuum Adapter      | (1)      |
| 40   | 43-44-0600 | Gasket              | (1)      |
| 41   | 06-97-4050 | 1/4" Lockwasher     | (4)      |
| 42   | 06-75-3090 | 1/4-20 x 7/8" Screw | (6)      |
|      | 49-96-0060 | 1/8" Hex Key        | (1)      |
|      | 49-96-0080 | 3/16" Hex Key       | (1)      |
|      | 49-96-0120 | 5/16" Hex Key       | (1)      |