



[Click Here To View](#)
[Item at](#)

www.GapPower.com

Sales • Rentals
Parts & Service

For Replacement Parts or Technical Assistance, Call 1-800-237-0987

Please provide following information:

- Model number
- Serial number (if any)
- Part description and number as shown in parts list

Address any correspondence to:

Wayne Water Systems
101 Production Drive
Harrison, OH 45030 U.S.A.

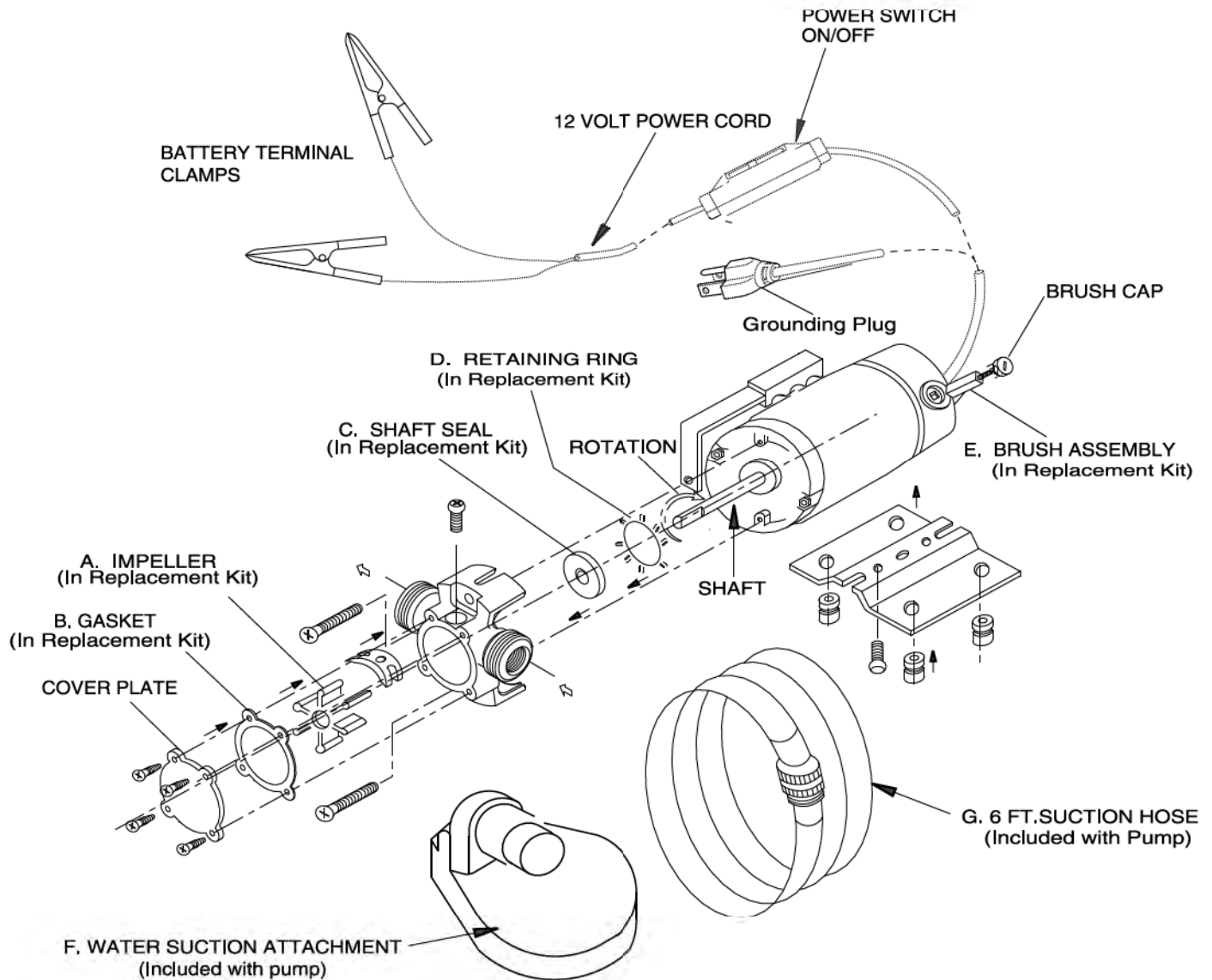

Figure 3 – Replacement Parts Illustration for Self-Priming Transfer Pumps

Replacement Parts List for Self-Priming Transfer Pumps

Reference Number	Description	Part Number for Models:		Quantity
		PC1	PC2	
1	Brush and Impeller Kit	66062-WYN1	66058-WYN1	
	A. Impeller			1
	B. Gasket			2
	C. Shaft Seal			1
	D. Retaining Ring			1
	E. Brushes			2
2	Brush Kit	66063-WYN1	—	
	E. Brushes			2
3	Water Suction Attachment	66064-WYN1	66064-WYN1	
	F. Water Suction Attachment			1
	G. 6 ft. Suction Hose			1

NOTE: Replacement parts are available in kit form only