

SERVICE DRAWING
J103H5-9P

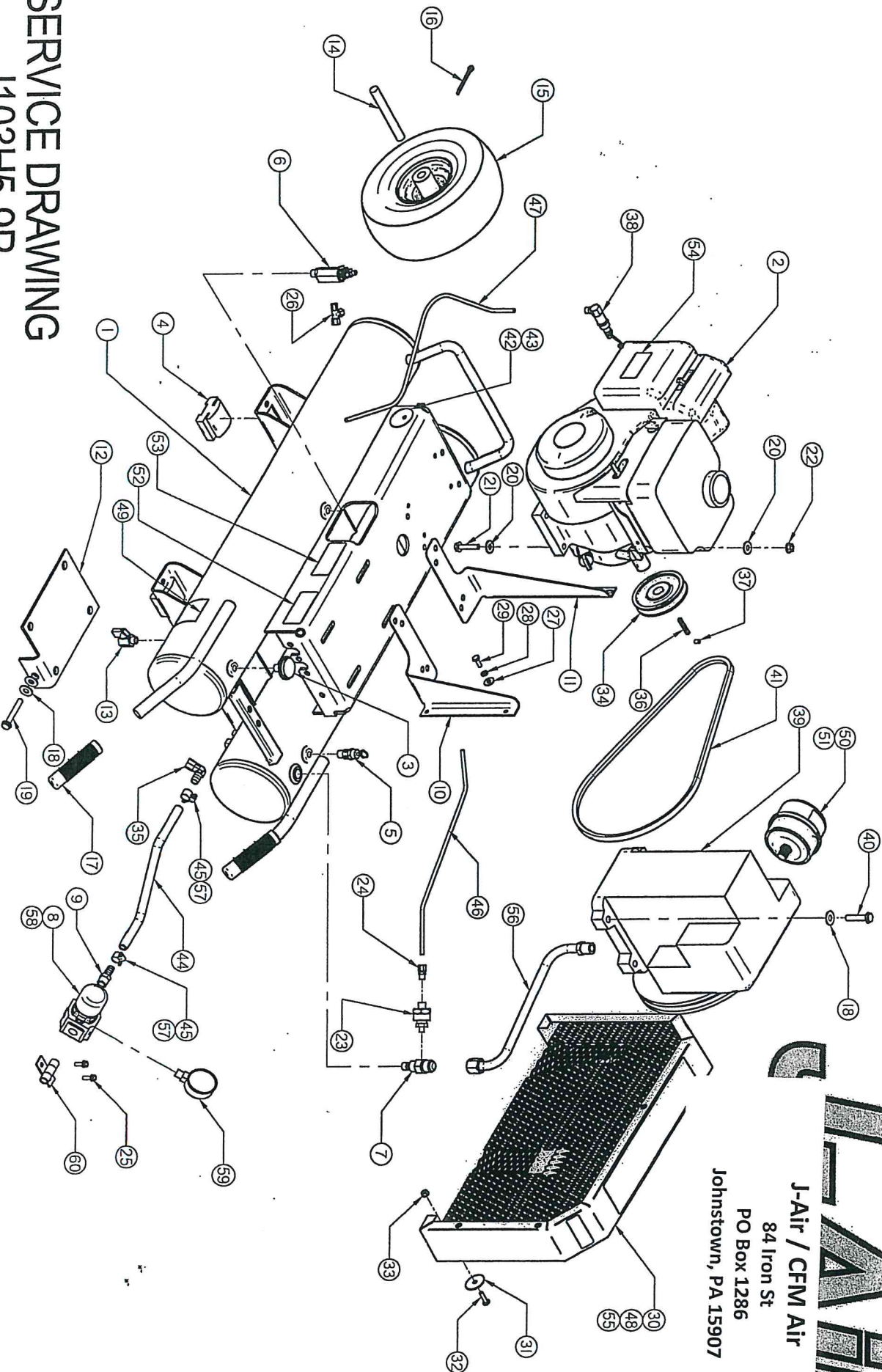

J-Air / CFM Air
84 Iron St
PO Box 1286
Johnstown, PA 15907

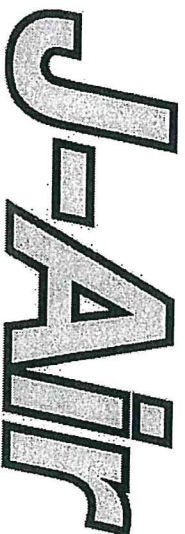

J-Air / CFM Air
 84 Iron St
 PO Box 1286
 Johnstown, PA 15907

Find No.	Part No.	Description	Quantity	Find No.	Part No.	Description	Quantity
1	111352-1	WELDMENT, 9P J103, STANDARD	1				
2	111493-1	ENGINE, HONDA, 55 HP	1				
3	111486-1	GAUGE	1				
4	111203-1	FOOTPAD	4				
5	111253-1	Safety Valve	1				
6	111482-1	PILOT VALVE	1				
7	111482-1	Check Valve	1				
8	111473-1	Regulator	1				
9	111247-1	Fitting, Hose Barb, 3/8 NPT to 1/2	1				
10	111419-1	SUPPORT, BELT GUARD, 113, RIGHT HAND	1				
11	111420-1	SUPPORT, BELT GUARD, 113, LEFT HAND	1				
12	111327-1	Nut Plate	1				
13	111252-1	Drain Valve	2				
14	111478-1	Axle	1				
15	111479-1	Tire	1	38	111515-1	THRUSTLE CONTROL	1
16	111480-1	COTTER PIN	2	39	111462-1	Pump, J103	1
17	111337-1	HANDLE GRP	2	40	111241-1	Bolt, 3/8-16 X 2	4
18	111242-1	Washer, 3/8	6	41	111507-1	BELT	1
19	111463-1	Bolt, 3/8-16 X 2 1/2	1	42	111482-1	SERIAL TAG	1
20	111463-1	FLATWASHER, 5/16, SAE	8	43	111481-1	FRCT, 1/8", BLIND	1
21	111501-1	Bolt, 5/16-18 X 1 3/4	4	44	111474-1	HOSE	1
22	111502-1	5/16-18 FLANGED LOCKNUT	4	45	111276-1	Crimp	2
23	111486-1	Unloader	1	46	111531-1	TUBE	1
24	111248-1	FITTING, 1/8 NPT X 1/4 TUBE	1	47	111532-1	Tube	1
25	111503-1	Bolt Hex Head, 1/4-20 X 3/4, Flanged	2	48	111296-1	UNIT WARNING LABEL	1
26	111491-1	TEE ASSEMBLY, RUN	1	49	111298-1	DRAIN TANK WARNING LABEL	2
27	111600-1	1/4" FLATWASHER	3	50	111231-1	FILTER ASSEMBLY	1
28	111601-1	1/4" SFLT RING WASHER	3	51	111299-1	PAPER ELEMENT CLEANING LABEL	1
29	111274-1	BOLT, 1/4-20 X 3/4 LG. OR 5, PLATED	3	52	111300-1	COMPRESSOR MAINTENANCE LABEL	1
30	111369-1	BELT GUARD	1	53	111301-1	INITIAL OIL FILL LABEL	1
31	111472-1	1/4" FENDER WASHER	4	54	111303-1	ENGINE STARTING PROCEDURE LABEL	1
32	111470-1	SCREEN, 1/4-20 X 1"	4	55	111310-1	HOT SURFACES WARNING LABEL	2
33	111256-1	Nut, Hex 1/4-20 Locking	2	56	111232-1	Air/coolant	1
34	111504-1	PULLY	1	57	111277-1	Cover, Clump End	2
35	111243-1	Fitting, Hose Barb, 90°, 3/8 to 1/2	1	58	111490-1	1/4 NPT Nut Plug - Recessed Hex	1
36	111290-1	Key	1	59	111279-1	Gauge	1
37	111291-1	Set Screw	2	60	111488-1	BRACKET, REGULATOR	1

J103H5-9P
 SERVICE PARTS