



[Click Here To View](#)
[Item at](#)

www.GapPower.com

Sales • Rentals
Parts & Service

THE SOLUTION OF RE-BAR TYING WORK

RE-BAR-TIER™ RB655



RE-BAR TYING SYSTEMS

BENEFITS

● REDUCES TYING TIME

About 5 times faster than manual tying. Make ties in approx. 1 sec. per tie with consistent tie strength. High speed tying saves you time and money.

● REDUCES RISK OF HEALTH PROBLEMS

Just pulling the trigger. The simple operation reduces potential wrist damage such as carpal tunnel injuries. Using the optional extension bar reduces the risk of back injuries.



Carpal tunnel syndrome



Extension bar (Option)

Both the National Institute for Occupational Safety and Health Construction Safety Association of Ontario reports state the MAX Re-bar Tying Tool reduces the risk of Carpal Tunnel Syndrome and other work related musculoskeletal disorders.

● BRUSHLESS TWISTING MOTOR

The brushless electric motor offers higher efficiency and longer lifetime. It increases ties per charge by 30% and does not require service caused by brush erosion or dirt on commutator.

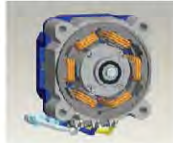

● 16 GA. TIE WIRE



The combination of 16 gauge tie wire and a powerful twisting motor insures a perfect tie every time. Wire usage is regulated automatically to match the size of the tie and increase productivity. One roll of wire ties 120 to 230 ties.

● TIES UP TO #9 x #8 RE-BARS

● ONE HAND OPERATION

Allows worker to hold re-bar while tying, reducing set up time.

APPLICATIONS



COMMERCIAL BUILDINGS / FOUNDATIONS / ROAD CONSTRUCTION / BRIDGES
PRECAST PLANTS / RADIANT HEATING TUBES / ELECTRICAL CONDUITS

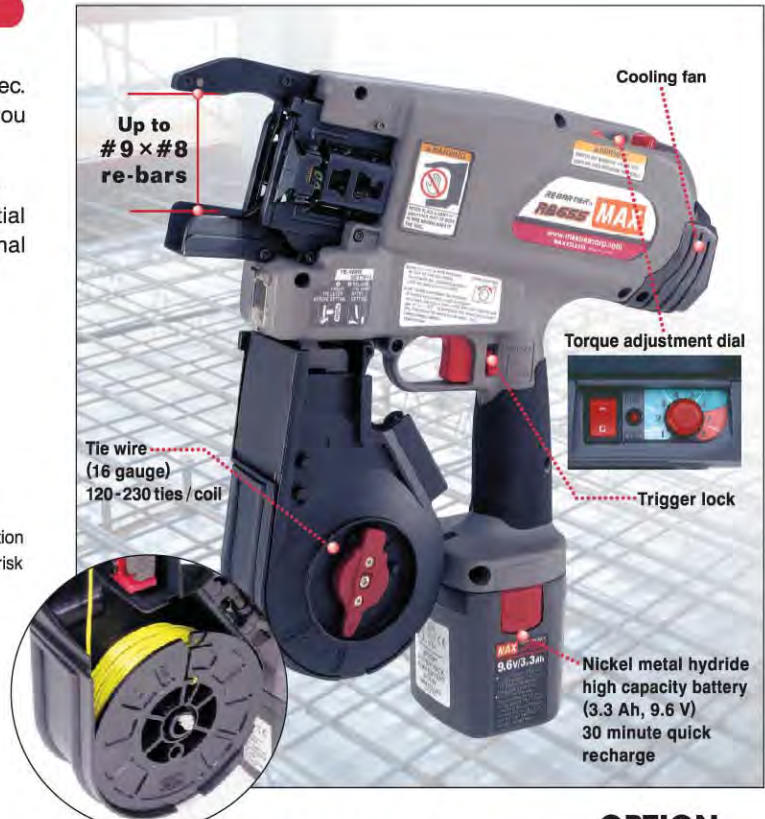

STANDARD EQUIPMENT

- 2 Batteries
- Battery charger
- Case ● Holster
- Instructional DVD (English & Spanish)



Holster (JH500)

OPTION

Extension bar (JE500)



TIE WIRE 16 ga. 50 coils / box

TW1525: Regular Steel wire



TW1525-EG: Electro galvanized wire



TW1525-PC: Polyester-coated wire



- US Patent Pending

SPECIFICATIONS

MODEL	RB655
WEIGHT	7.2 lbs.
DIMENSIONS	13-3/8"(H) x 4"(W) x 13-3/8"(L)
TYING SPEED	0.8 - 1.1 seconds / tie
TIES PER COIL	120 - 230 ties / coil
TIES PER CHARGE	2 - 3 coils / charge
MAXIMUM BAR SIZE COMBINATION	#9 x #8
BATTERY	JP509H (Ni-Mh Battery)
VOLTAGE	DC 9.6V (3.3 Ah)
RECHARGE TIME	Approx. 30 minutes

The specifications and design of the products in this catalog will be subject to change without advance notice due to our continuous efforts to improve the quality of our products.



MAX USA CORP.

257 East 2nd Street Mineola, New York 11501
Phone: 800-223-4293 Fax: 516-741-3272
www.maxusacorp.com

Dealer: