

Eastwood

DO THE JOB RIGHT.

Part #14771

CONCOURS PRO **HVLP PAINT GUN** **INSTRUCTIONS**

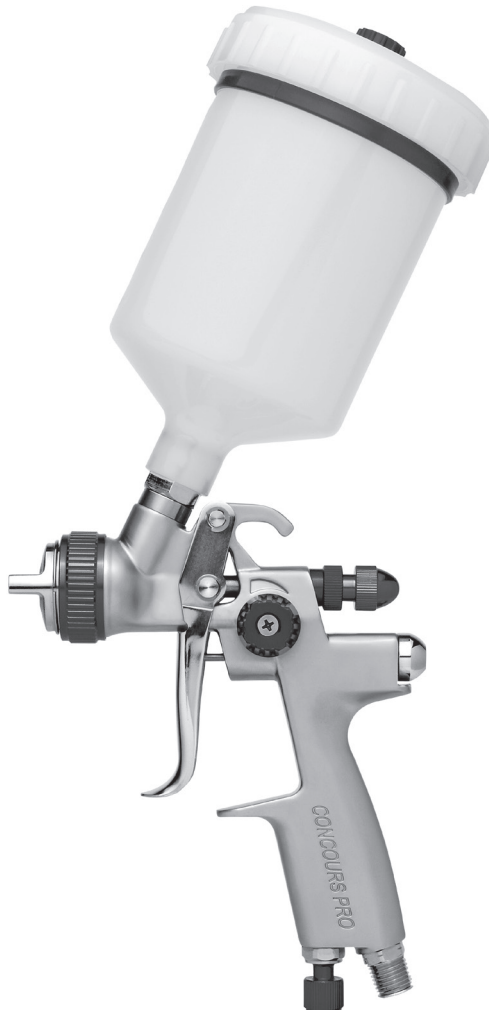

The Eastwood Concours PRO HVLP Paint Gun is a top quality, true professional level paint gun specifically designed for optimal internal paint and air flow. Offering precise control and fine atomization, this paint gun is capable of producing finish results equal or superior to many of the more popular premier HVLP paint guns.

INCLUDES

- (1) HVLP Paint Gun with 1.3mm fluid nozzle
- (1) 600cc Acetyl Paint Cup
- (1) Cleaning set
- (1) Manifold Removal Tool



SPECIFICATIONS

- 6.5 CFM @ 30 psi (2 to 2.5 Bar)
- 1/4" male NPT input threads
- M16 x 1.5 NPS paint cup attachment threads
- 1.3mm stainless steel needle/nozzle set (others available)

SAFETY INFORMATION



READ INSTRUCTIONS!

Read and understand all instructions thoroughly.



FIRE & EXPLOSION HAZARD!

Do Not use near sparks, open flame or other potential ignition source.



HEALTH HAZARD!

- Avoid breathing vapors produced by Spray Gun. Always wear appropriate NIOSH approved breathing apparatus and use in a well ventilated area.
- Wear appropriate eye protection.
- Wear solvent-resistant gloves.

SET-UP

- Remove all components from carton, identify them and become familiar with their purpose.
- A 5/16" I.D. minimum air hose at a 25' maximum length is strongly recommended for best results. Smaller I.D. hose and greater length may produce unsatisfactory results.
- A clean, dry, regulated air supply is required. The use of an additional "on the gun" regulator is strongly recommended to accurately control gun pressure while painting.
- Clean out the paint cup as well as the paint gun air and paint passages with a solvent such as Eastwood PRE or acetone to remove any residual manufacturing impurities before use. Dry thoroughly.

GUN SETTINGS

- **Air Cap** – Make sure the Air Cap is properly oriented in a horizontal plane to produce a vertical fan spray pattern (as viewed from the front). To adjust, loosen Retaining Ring by rotating counter-clockwise slightly, adjust Air Cap then re-tighten Retaining Ring (Fig A).
- **Fluid Control** – The Fluid Control knob (located at top rear of gun body) regulates the distance the Needle travels and the amount of paint flowing through the gun. Note: Generally for higher viscosity coatings, a wider opening is desired while a narrower opening is better suited for lower viscosity fluids. To adjust, rotate the Fluid Control Knob outward (counter-clockwise as viewed from the rear) to increase flow and turn inward to reduce flow (Fig A).
- **Fan Control** – The Fan Control knob (located at the upper left side of the paint gun body) controls the size and shape of the spray pattern or “fan”. Rotating the knob counter-clockwise will produce a larger and softer spray pattern. While rotating it clockwise will result in a smaller, sharper pattern. For most painting conditions, a larger, softer fan is desired (Fig A).
- **Air Control** – The Air Control knob (located at the bottom of the gun handle adjacent to the air inlet) is opened by rotating in a counter-clockwise direction (as viewed from the bottom of the gun). This is for “fine tuning” the airflow to the gun. You will generally want to set the inlet pressure at the regulator, start with the Air Control in the full open position and decrease air as needed (Fig A).
- With practice, you will quickly acquire a “feel” for the gun and will be producing professional results.
- When you have achieved your optimal knob settings, note their positions with the indicators on the gun body and knobs. This will assist in quickly “tuning” the gun for future uses.

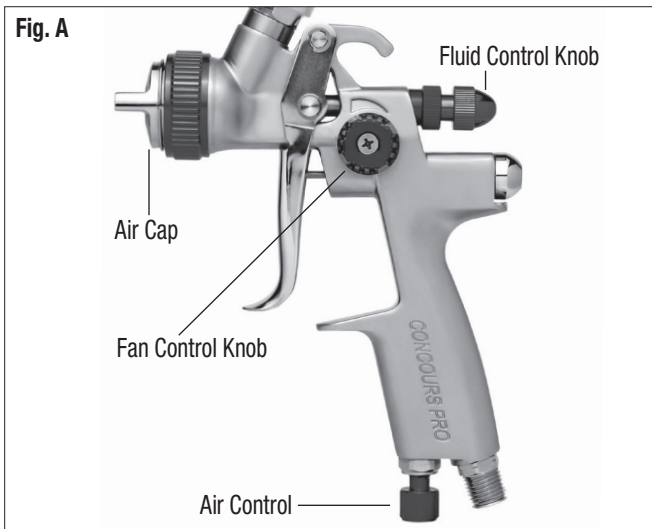

IMPORTANT NOTES BEFORE PAINTING

1. Please note that many variables may affect the adjustment of a paint gun including paint viscosity and type, atmospheric conditions such as humidity, barometric pressure and temperature, as well as air inlet pressure and operator preference. Always “tune” the gun before each use as prevailing conditions may not be the same as the previous use.
2. It is always best to test spray, the actual paint you will be applying, on sheets of cardboard or masking paper while making your adjustments to become familiar with the gun and achieve the ideal Fluid Control Setting.
3. Remember that a small amount of product wasted at this point can avoid disappointment in your results and the need to re-do your work later.

CLEAN-UP

- Disconnect air supply to gun.
- Remove Paint Cup and pour unused coating into proper container.
- Wipe out any excess coating then thoroughly rinse the Paint Cup with a mild solvent compatible with the coating being used.
- Fill Paint Cup with solvent and pull the trigger to allow fluid to run through until it flows clear. Note, as an alternative, #12846Z Eastwood Aerosol Injected Gun Cleaner is excellent for this purpose.
- Pour out any unused solvent and remove paint cup.
- Allow solvent to dry completely from all components.
- Dispose of waste solvents and all other liquid materials according to your local laws and regulations.

PAINT GUN DISASSEMBLY FOR ADDITIONAL CLEANING OR REBUILDING

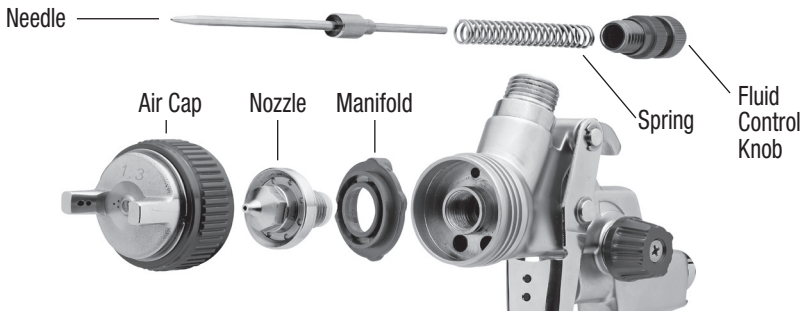

- Remove Air Cap Assembly.
- Remove Nozzle with included 12mm wrench.
- Unthread and remove Fluid Control Knob from rear of Paint Gun body.
- Carefully remove Tension Coil Spring with Bushing and Needle by firmly gripping rear of Needle and pulling out through rear of Paint Gun body (Fig B).
- Remove brown plastic Air Manifold. (Note: position of locating pin on manifold to bore in Paint Gun body for re-assembly) with special removal tool by placing hooks facing downward, through manifold openings, under spokes and pulling directly outward toward front of Gun Body (Fig C & D).
- Inspect and clean as required.
- Replace Air Manifold (be sure to correctly position the locating pin on manifold into bore in Paint Gun body).
- Replace Needle by sliding into bore in rear of Paint Gun body until it seats.
- Slide Needle Tension Spring w/bushing over the rear of the Needle (Fig. E)
- Replace Nozzle by threading into front of Gun Body and tighten firmly with included 12mm wrench (Do not over tighten).
- Replace Air Cap by threading Retaining Ring onto Gun Body. Make sure the air horns of the Air Cap are oriented properly.

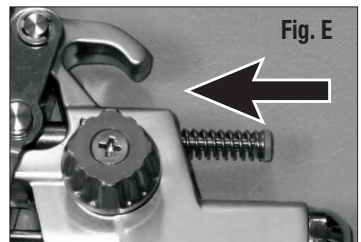
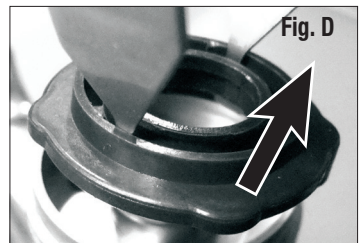
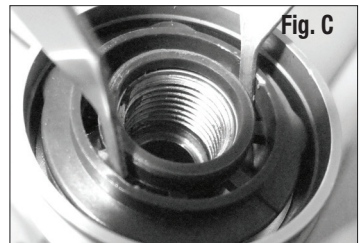
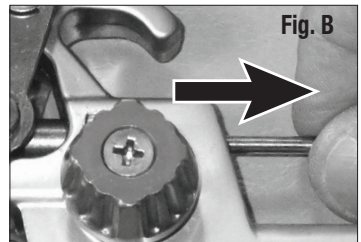

TROUBLE-SHOOTING

- Gun produces an uneven spray pattern or fan:
 - Paint or film buildup on Air Cap blocking air holes.
Disconnect air supply and clean buildup from Air Cap.
- Gun “spits” or sputters; discharges large droplets:
 - Paint or film buildup on Needle & Nozzle.
Disconnect air supply and clean buildup from Needle & Nozzle.
Note: Use of solvent may be helpful, removal of the Nozzle may be necessary.
- Gun draws only a small amount of paint or none at all:
 - Clump or piece of paint film blocking Pickup Tube.
Disconnect air supply; remove Paint Cup and Pickup Tube.
Remove blockage from Pickup Tube then strain paint or coating to remove clumps or film.

ADDITIONAL ACCESSORIES

- # 14773 1.3mm Needle/Nozzle Set
- # 14774 1.7mm Needle/Nozzle Set
- # 14775 2.0mm Needle/Nozzle Set
- # 10041Z Eastwood PRE Painting Prep, Aerosol
- # 12846Z Aerosol Injected Cleaner
- # 11455-11456 Respirators
- # 20403-20406 Coveralls
- # 11472 Concours PRO Detail Gun
- # 51550B 600cc Aluminum Cup
- # 50207 DeKups® Adapter
- # 11549 3M® PPS Adapter
- # 14049 Gunner® Cup Adapter

If you have any questions about the use of this product, please contact

The Eastwood Technical Assistance Service Department: 800.544.5118 >> email: techhelp@eastwood.com

PDF version of this manual is available online >> eastwood.com/14771manual

The Eastwood Company 263 Shoemaker Road, Pottstown, PA 19464, USA

US and Canada: 800.345.1178 Outside US: 610.718.8335

Fax: 610.323.6268 eastwood.com