



Click Here To View  
Item at

[www.GapPower.com](http://www.GapPower.com)

*Sales • Rentals  
Parts & Service*

## NOZZLE

- The AIR-SPADE nozzle can be unscrewed from the barrel by turning counter-clockwise. In the event of a tighter than normal connection, flats are provided on the nozzle for wrench application. Before re-installing the nozzle, remove any dirt or foreign material from the threads and o-ring, and apply a small amount of commercial grade anti-seize compound on the threads to prevent galling. Screw the nozzle into the barrel by turning clockwise. **Hand-tighten only.**

## BARREL

- The fiberglass barrel can be unscrewed from the handle by turning counter-clockwise. In the event of a tighter than normal connection, a spanner wrench may be used on the barrel if necessary. Before re-installing the barrel into the handle, remove any dirt or foreign material from the threads and o-ring, and apply a small amount of anti-seize compound on the threads to prevent galling. Screw the barrel into the handle by turning clockwise. **Hand-tighten only.**

## EXTENSIONS

- Extensions provide the ability to extend the reach of the AIR-SPADE into deeper holes or trenches. To install an extension, first remove the nozzle. Apply a small amount of anti-seize compound on the threads of the barrel, then attach the extension to the barrel by screwing it into the barrel. Turn clockwise and **hand-tighten only.** Apply a small amount of anti-seize compound on the threads of the extension, then screw on the nozzle. **Hand-tighten only.**



## 45° ADAPTER

- The 45° adapter enables the AIR-SPADE to operate in tight locations where obstructions do not allow the use of a straight barrel. It can be installed by hand with no tools required. Remove the existing nozzle from the barrel. Ensure the 45° adapter locking ring is shouldered against the 45° adapter body and the 45° adapter coupler is snug against the o-ring. Clean the threads and the o-rings on the barrel and on the 45° adapter assembly and apply anti-seize compound to the threads of both. Screw the 45° adapter assembly onto the barrel via the coupler. **Hand-tighten only.** Screw the nozzle onto the other end of the 45° adapter. **Hand-tighten only.** To lock the adapter into position, shoulder the locking ring against the coupler.

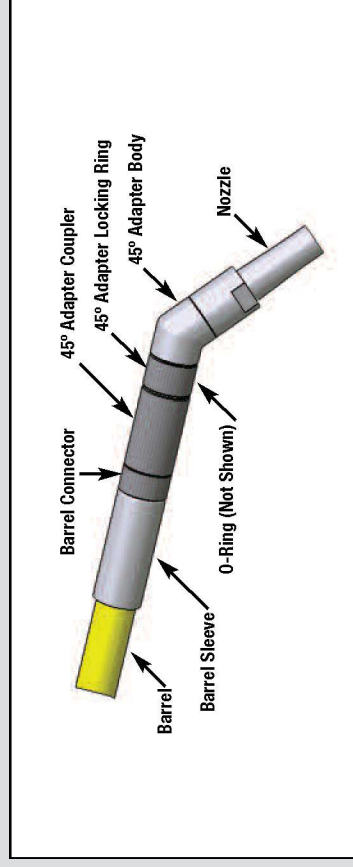

**CAUTION:** When using the 45° adapter, compressed air exiting the nozzle will force the tip of the tool away from the direction the nozzle is aimed. To prevent this from occurring, the operator should place the free hand at least midway down the barrel. Grip the barrel tightly to brace the tool against the force produced by the exiting compressed air.



## SLIDING DIRT SHIELD



- The sliding dirt shield is made up of two components: the locking sleeve (A) and rubber deflector (B). One end of the locking sleeve has 4 slots; the other end is solid.

- To install, slide the rubber deflector over the nozzle and coupling into position (C) on the barrel. Separate the locking sleeve and clamp over the barrel in position (D). Make sure the slots are closest to the nozzle. (Fig.1)

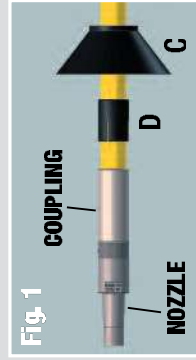

- Slide the rubber deflector so that it is positioned over the solid end of the locking sleeve. The locking sleeve and rubber deflector assembly can now slide freely up and down the barrel shaft. (Fig.2)

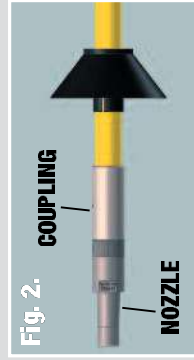

- To lock the sliding dirt shield in position, slide the assembly to the desired position on the barrel. Then firmly push the rubber deflector over the slotted end of the locking sleeve. (Fig.3)

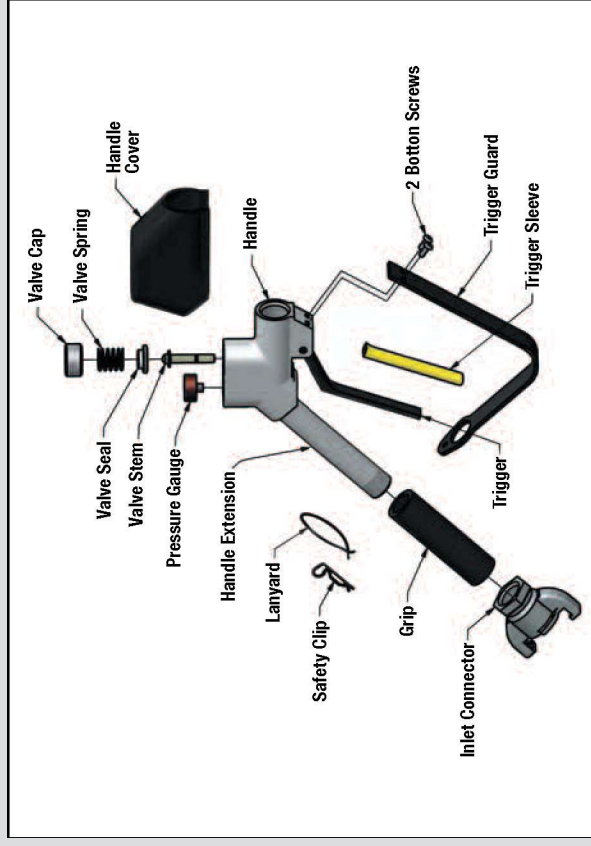

## HANDLE SPARE PARTS KITS

- AIR-SPADE Series 2000 Handle Spare Parts Kit includes:
  - Valve Spring
  - Valve Seal
  - Valve Stem
  - Pressure Gauge
  - Lanyard
  - Safety Clip
  - Grip
  - Trigger Sleeve
  - 2 Button Screws
  - Lubricant

## PRESSURE GAUGE

- The pressure gauge may be removed with a valve removal tool by turning counter clockwise. Valve removal tools are commonly available at any auto parts store. Before re-installing, apply a small amount of thread locker on the gauge stems threads. Insert the gauge into the handle cavity, turning clockwise by hand as far as possible. Tighten using the suction cup tool.

## VALVE STEM

- Remove the plastic, snap-on handle cover by drawing the cover towards the rear of the tool. Unthread the valve cap (1/2" square drive required) and set aside. Remove and discard the valve spring, valve seal, and valve stem. Apply lubrication to the new valve stem and insert into the handle. Insert a new valve seal with the black seal face facing downwards. Insert a new valve spring. Apply Teflon tape to the threads of the existing valve cap and thread into the handle until flush. Slide the existing handle cover back in place.

## INLET CONNECTOR

- Remove the plastic, snap-on handle cover. Carefully snug the AIR-SPADE handle casting in a vise. Unscrew the inlet connector by turning it counter-clockwise. Exercise caution not to unscrew the handle extension from the handle casting. Before re-installing the connector, wrap the treads of the handle extension with Teflon tape to prevent galling the threads and to insure an air-tight connection. Tighten by wrench.

## TRIGGER SLEEVE AND COMFORT GRIP

- Unthread the inlet connector per the previous instructions. Remove the two button screws holding the trigger guard. Slide the trigger guard off the handle and save. Remove grip and discard. Slide on the new grip, and trigger sleeve. Applying talc or evaporating solvent to the inside will ease installation. Position the trigger guard on the handle. Thread the two new screws into the handle. Apply threaded locker to the two new button screws and thread into the handle. Before reinstalling the inlet connector, wrap the treads with Teflon tape to prevent galling the threads and to insure an air-tight connection. Tighten by wrench.

## Part # Description

HT57	1" ID x 10 FT LIGHTWEIGHT AIR SUPPLY HOSE
HT101	AIR SPADE 2000 UTILITY/CONSTRUCTION KIT WITH 60 SCFM NOZZLE
HT102	AIR SPADE 2000 UTILITY/CONSTRUCTION KIT WITH 225 SCFM NO771 F
HT106	AIR SPADE 2000 UTILITY/CONSTRUCTION KIT WITH 150 SCFM NO771 F
HT107	AIR SPADE 2000 ARBOR/1 ANDSCAPT KIT WITH 150 SCFM NO771 F
HT108	AIR SPADE 2000 TRFUCH TRFCUT KIT WITH 60 SCFM AND 150 SCFM NO771 FS
HT109	AIR SPADE 2000 ARBOR/1 ANDSCAPL KIT WITH 225 SCFM NOZZLE
HT111	1" ID x 25 FT LIGHTWEIGHT AIR SUPPLY HOSE
HT112	1" ID x 50 FT LIGHTWEIGHT AIR SUPPLY HOSE
HT113	1" ID x 50 FT AIR SUPPLY HOSE
HT114	AIR SPADE 2000 UTILITY/CONSTRUCTION KIT WITH 105 SCFM NOZZLE
HT116	AIR SPADE 2000 150 SCFM NOZZLE WITH 3 FT BARREL
HT117	AIR SPADE 2000 HANDLE ASSEMBLY
HT118	AIR SPADE 2000 4 FT BARREL WITH DIRT SHIELD
HT119	AIR SPADE 2000 45 DEG TIE ANGLE ADAPTER
HT120	AIR SPADE 2000 5 FT EXTENSION WITH COUPLER
HT121	AIR SPADE 2000 3 FT EXTENSION WITH COUPLER
HT122	AIR SPADE 2000 2 FT EXTENSION WITH COUPLER
HT123	AIR SPADE 2000 150 SCFM NO771 F
HT125	AIR SPADE 2000 60 SCFM NO771 F
HT126	AIR SPADE 2000 25 SCFM NOZZLE
HT127	AIR SPADE 2000 225 SCFM NOZZLE
HT129	AIR SPADE 2000 150 SCFM NOZZLE WITH 40" BARREL
HT130	AIR SPADE 2000 150 SCFM NOZZLE WITH 4 FT BARREL
HT131	AIR SPADE 2000 150 SCFM NOZZLE WITH 3 FT BARREL
HT132	AIR SPADE 2000 STORAGE CASE WITH LOCK
HT133	AIR SPADE 2000 SLIDING DIRT SHIELD ASSEMBLY
HT134	AIR SPADE 2000 60 SCFM NO771 F WITH 4 FT BARR1
HT135	AIR SPADE 2000 PRESSURE GAUGE
HT136	FACE SHIELD & HEADGEAR
HT138	AIR SPADE 2000 225 SCFM NO771 F WITH 4 FT BARR1
HT139	AIR SPADE 2000 105 SCFM NO771 F WITH 4 FT BARR1
HT140	AIR SPADE 2000 25 SCFM NOZZLE WITH 4 FT BARREL
HT150	AIR SPADE 2000 HANDLE SPARE PARTS KIT
HT154	AIR SPADE 2000 4 FT EXTENSION WITH COUPLER
HT156	AIR SPADE 2000 105 SCFM NOZZLE
HT165	AIR SPADE 2000 3/4" TPI T NOZZLE ADAPTER
HT171	STORAGE BAG, CANVAS
HT180	AIR SPADE 2000 AUXILIARY HANDLE ASSEMBLY
LT24	AIR SPADE 3000 330 SCFM NOZZLE
LT3000	AIR SPADE 3000 330 SCFM NO771 F WITH 55" BARR1, 4 PRONG CONNECTOR
LT3000.01	AIR SPADE 3000 330 SCFM NO771 F WITH 55" BARR1, 2 PRONG CONNECTOR



# Limited Warranty



AIR-SPADE Series 2000 is warranted by GUARDAIR CORPORATION (GUARDAIR) against defects in material and workmanship for a period of one year. Defective units will be replaced or repaired at the option of GUARDAIR. The warranty period begins at the date of shipment of the tool from GUARDAIR or from GUARDAIR'S authorized distributor.

This warranty shall not be in effect if the tool is subject to misuse, negligence, or accident, or if it is configured, or used in any manner inconsistent with the directions set forth in this operator's manual. Wear and tear from normal use is not covered under this warranty.

Any and all claims for warranty consideration must be coordinated through GUARDAIR. Do not return the unit or parts without prior authorization. Upon obtaining authorization, returned units or parts must be postage prepaid.

The purchaser's recovery for damages resulting from any and all causes whatsoever, including, but not limited to, breach of contract, breach of warranty, negligence or strict product liability will be limited to the replacement of the components of the tool with respect to which losses or damages are claimed, provided that GUARDAIR has been notified of any alleged defect within the warranty period.

---

**IN NO EVENT SHALL GUARDAIR CORPORATION BE LIABLE TO THE PURCHASER OR ANY USER OF THE AIR-SPADE, OR TO ANY OTHER PERSON OR ENTITY, FOR INDIRECT, INCIDENTAL, OR CONSEQUENTIAL DAMAGES INCLUDING THE COST OF PROVIDING SUBSTITUTE EQUIPMENT DURING PERIODS OF MALFUNCTION OR NONUSE AND DAMAGES FOR DELAY. THE WARRANTIES AND REMEDIES SET FORTH ABOVE ARE THE SOLE AND EXCLUSIVE WARRANTIES AND REMEDIES AVAILABLE. GUARDAIR CORPORATION SPECIFICALLY DISCLAIMS ALL IMPLIED WARRANTIES OF MERCHANTABILITY AND FITNESS FOR A PARTICULAR PURPOSE AND ALL OTHER WARRANTIES, WHETHER EXPRESS, IMPLIED OR STATUTORY.**

---

**GUARDAIR**<sup>®</sup>  
CORPORATION

**The Most Powerful,  
Compressed  
Air-Powered,  
Excavation Tool  
Available On the  
Market Today.**

**Featuring  
the Patented  
AIR-SPADE  
Supersonic  
Nozzle**

**For the  
biggest,  
toughest  
excavation  
jobs...**

**AIR-SPADE  
3000**

**CHECK IT OUT AT  
[www.air-spade.com](http://www.air-spade.com)**

