



Click Here To View  
Item at

[www.GapPower.com](http://www.GapPower.com)

*Sales • Rentals  
Parts & Service*

# Demco

## Kar-Kaddy 3

### KK370SB

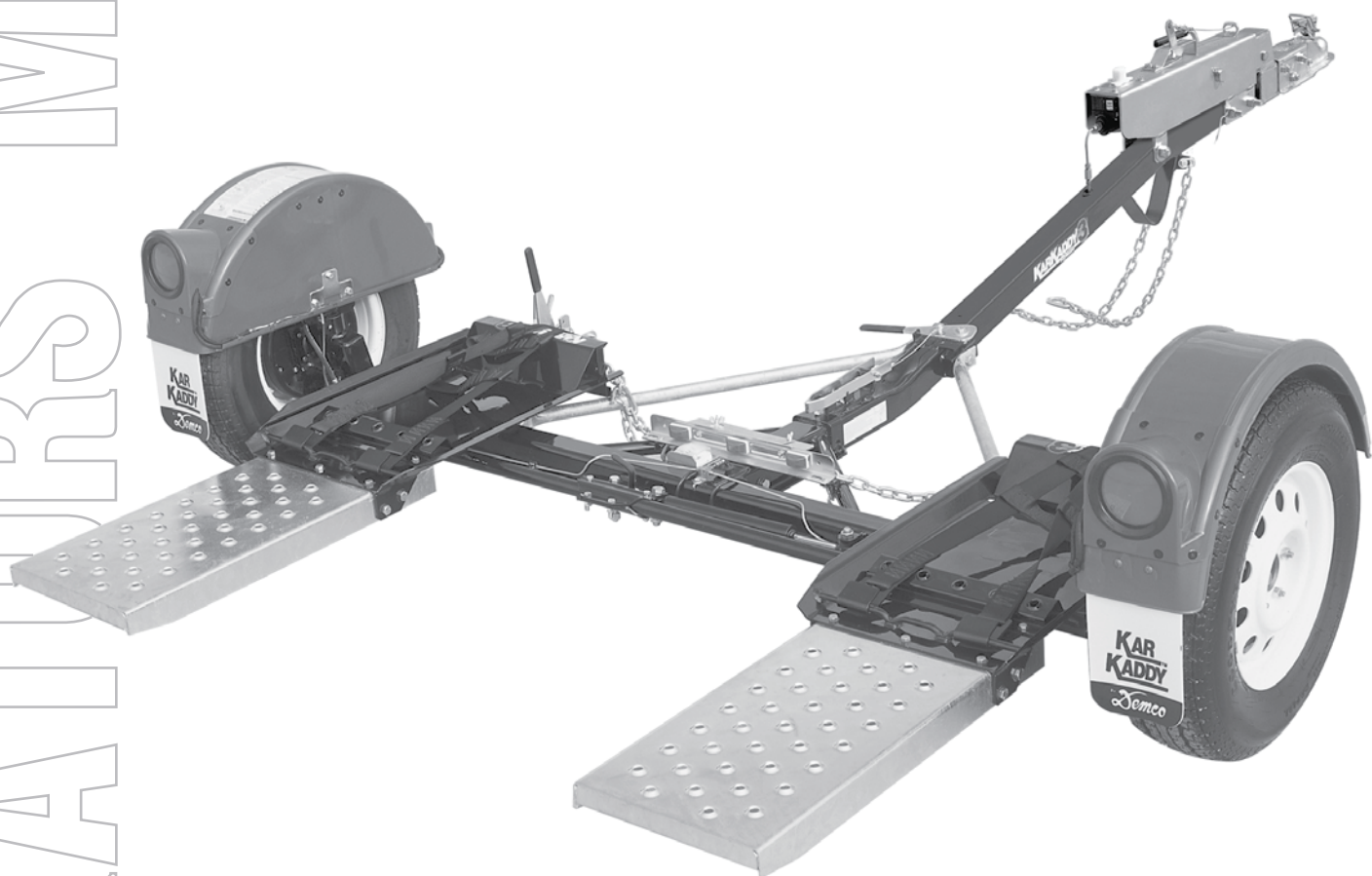

ASSEMBLY  
CALIBRATION  
OPERATION  
REPLACEMENT PARTS

**READ** *complete manual CAREFULLY*  
*BEFORE attempting operation.*

*Doing Our Best To Provide You The Best*

OPERATORS MANUAL

## Introduction

Thank you for purchasing a Demco Kar-Kaddy. We feel you have made a wise choice and hope you are completely satisfied with your new piece of equipment.

## GENERAL INFORMATION

1. Unless otherwise specified, high-strength (grade 5) (3 radial-line head markings) hex head bolts are used throughout assembly of this piece of equipment.
2. Whenever the terms “LEFT” and “RIGHT” are used in this manual it means from a position behind the Kar-Kaddy and facing forward.
3. When placing a parts order, refer to this manual for proper part numbers and place order by **PART NO. and DESCRIPTION.**

## TABLE OF CONTENTS

General Information.....	Page 2
Tow Dolly safety guide.....	Page 3-10
Bolt Torque.....	Page 11
Tongue & Ramp Installation.....	Page 12
Fender Assembly Installation.....	Page 13
Safety, Maintenance, & Important Loading Instructions .....	Page 14
Loading Angle Clearance Guide.....	Page 14
Loading Instructions .....	Page 15-17
Kar-Kaddy KK370SB Parts Breakdown and List.....	Page 18-19
Winch Assembly.....	Page 20
Latch Assembly.....	Page 20
License Plate Bracket Assembly .....	Page 21
Fender Assembly.....	Page 21
Limited Warranty Information.....	Page 22
DA91 Brake Actuator Parts Breakdown and List.....	Page 23
10" Self-Adjusting Brake Cluster Parts Breakdown and List.....	Page 24
Surge Brakes Parts Breakdown and List.....	Page 25
Testing Lights Before Use.....	Page 26
Wiring Diagram.....	Page 26
Kar-Kaddy Toe-In Adjustment.....	Page 27
Wheel Jack, Deflector, & Light Bar (optional) Parts Breakdown and List .....	Page 28
Winch, Tool Box, & Spare Tire w/Mounting Bracket (optional) Parts Breakdown and List.....	Page 31

### “Reporting Safety Defects”

If you believe that your vehicle has a defect which could cause a crash or could cause injury or death, you should immediately inform the National Highway Traffic Safety Administration (NHTSA) in addition to notifying Dethmers Manufacturing Company (DEMCO).

If NHTSA receives similar complaints, it may open an investigation, and if it finds that a safety defect exists in a group of vehicles, it may order a recall and remedy campaign. However, NHTSA cannot become involved in individual problems between you, your dealer, or Dethmers Manufacturing Company (DEMCO).

To contact NHTSA, you may either call the Auto Safety Hotline toll-free at 1-800-424-9393 (or 366-0129 in Washington, D.C. area) or write to:

NHTSA,  
U.S. Department of Transportation  
Washington, D.C. 20590.

You can also obtain other information about motor vehicle safety from the Hotline.

## SAFETY

**TAKE NOTE! THIS SAFETY ALERT SYMBOL FOUND THROUGHOUT THIS MANUAL IS USED TO CALL YOUR ATTENTION TO INSTRUCTIONS INVOLVING YOUR PERSONAL SAFETY AND THE SAFETY OF OTHERS. FAILURE TO FOLLOW THESE INSTRUCTIONS CAN RESULT IN INJURY OR DEATH.**



**THIS SYMBOL MEANS**

**-ATTENTION**

**-BECOME ALERT**

**-YOUR SAFETY IS INVOLVED!**

### **SIGNAL WORDS**

This manual uses the following signal words-- **DANGER**, **WARNING**, and **CAUTION**-- with safety messages. The appropriate signal word has been selected using the following guidelines.

#### **DANGER:**

Indicates an imminently hazardous situation that, if not avoided, will result in death or serious injury. This signal word is to be limited to the most extreme situations typically for tow dolly components which, for functional purposes, cannot be guarded.

#### **WARNING:**

Indicates a potentially hazardous situation that, if not avoided, could result in death or serious injury, and includes hazards that are exposed when guards are removed. It may also be used to alert against unsafe practices.

#### **CAUTION:**

Indicates a potentially hazardous situation that, if not avoided, may result in minor or moderate injury. It may also be used to alert against unsafe practices.

If you have questions not answered in this manual, or require additional copies, please contact your dealer or Demco, P.O. Box 189, 4010 320th Street, Boyden, IA 51234, ph: (712) 725-2311  
Toll Free: 1-800-543-3626 Fax: (712) 725-2380 <http://www.demco-products.com>

## TOW DOLLY USER GUIDE



### WARNING

Read the following information completely before hooking up, loading, using unloading or unhooking this Tow Dolly.



**FAILURE TO FOLLOW THESE SAFETY INSTRUCTIONS  
MAY LEAD TO DAMAGE TO PROPERTY, SEVERE PERSONAL INJURY, AND/OR DEATH.**

- Read towing instructions in towed vehicle's owner's manual.
- Read towing instructions in towing vehicle's owner's manual. Be certain that your towing vehicle has the capacity to tow a tow dolly and towed vehicle combination. **IF YOU HAVE ANY QUESTIONS ABOUT THIS, DO NOT TOW. CONSULT YOUR DEALER OR CALL DEMCO.**
- Use a 2", 5000 lb. (or greater) capacity ball for a tow dolly without surge brakes and a 2", 6000 lb. (or greater) capacity ball for a tow dolly with surge brakes.
- Make sure towing vehicle's parking brake is fully engaged before starting hookup, loading, unloading, or unhooking of tow dolly.
- Do not load towed vehicle onto tow dolly until tow dolly is completely and properly hooked up to towing vehicle and setting on a level surface.
- Tail lights and stop lights must be hooked up and operating properly at all times.
- Do not load a towed vehicle that exceeds weight or size limits of tow dolly.
- Always have someone safely guide you when driving towed vehicle onto tow dolly.
- Be sure tires of your towed vehicle and tow dolly are in good condition and inflated to proper pressures. Tire pressure may increase during travel—do not bleed off extra pressure.
- Do not back up your towing vehicle when a tow dolly is attached. A tow dolly swivels both at the coupler and at car platform. If you must back up, unload towed vehicle first, disconnect tow dolly and move vehicle and tow dolly separately. Park where you can pull ahead when leaving.
- Do not exceed 55 miles per hour, or any lower posted speed limit.
- Avoid sharp turns or swerves.
- Braking distance increases when using a tow dolly. Use caution and always allow sufficient distance for braking.
- Do not transport passengers or cargo in vehicle being towed.
- Do not unhook tow dolly from towing vehicle until towed vehicle is completely unloaded from tow dolly.

- Allow one tow-vehicle/tow dolly/vehicle-in-tow length for each 10 m.p.h. behind another vehicle.
- ALWAYS check the hitch, tow dolly and vehicle-in-tow at each stop to insure that coupling, chains and tie down equipment remain tight and properly attached. Use tow dolly checklist as an aid.
- NEVER tow without properly installed tire straps and security chains properly attached to frame or other structural member of vehicle-in-tow.
- ALWAYS slow down—40 miles per hour or less—for curves, wet or rough roads, and downgrades. On downgrades, shift into a lower gear and allow engine to help hold speed down.
- ALWAYS be rested. NEVER drive when fatigued.
- AVOID driving at night. Night drivers have three times the fatality rate of day drivers.
- NEVER continue to operate an unstable (swaying or whipping) combination. If this occurs, slowly pull over, reducing speed through your engine rather than braking. When stopped in an off the road location check hitch, tire straps, and chains.
- NEVER pass on hills or curves. Beware of cross winds and wind gusts from passing vehicles.
- NEVER transport passengers or cargo in towed vehicle.
- ALWAYS load vehicle-in-tow facing forward. NEVER back onto tow dolly. For maximum stability steering axle must be on tow dolly.
- ALWAYS disconnect drive shaft of a rear wheel drive/front engine vehicle-in-tow at differential to avoid transmission damage. Secure disconnected parts.
- ALWAYS ensure vehicle-in-tow parking brake is disengaged before towing.
- ALWAYS keep children, pets, and bystanders clear of area while loading and unloading.



### **THE MOST IMPORTANT PART - IS YOU**

Will you read and follow these instructions on how to safely operate this Dethmers Tow Dolly?

If your answer is YES, we thank you for your attitude and believe your towing experience will be a safe and pleasant one.



### **SAFETY CHECKLIST**

While Stopped Check

- That Hitch is Tight
- That Hitch Ball is Tight
- Coupler Lever Lock
- Are Tire Tie Down Straps Tight
- Are Hitch Safety Chains and Vehicle-in-Tow Frame Security Chains Properly Attached
- Are Tire Pressures OK
- Vehicle-in-Tow for Working Lights
- Are Drive Shaft and Battery Cable Disconnected and Secured If Required



When On the Road:

- Reduce Speed
- Think Ahead
- Allow for extra length when turning
- Anticipate Stops/Brake Early
- Stop Often for Rest
- Use Safety Checklist at Each Stop



### **TOWING VEHICLE SIZE AND TOWING CAPACITY**

Towing vehicle must weigh at least 750 lbs. more than weight of vehicle-in-tow. Example: A 2,750 lb. car may tow no more than a 2,000 lb. car.



### **Suspension**

Your tow vehicle's rear springs must be of sufficient strength to support the added loaded tow dolly tongue weight while maintaining tow vehicle in approximately a level position. If rear springs, shock absorbers, or struts, are weak or broken, they must be replaced. In some cases, it may be necessary to add helper springs or air shocks to help support weight properly. Poor wheel alignment, loose steering or worn suspension components can also adversely affect vehicle handling and stability.



### **Sport Utility Vehicles**

Exercise caution when towing with a sports utility (e.g., Jeep or Bronco) type vehicle. Some of these vehicles have a higher than normal center of gravity, and a short wheelbase. This gives them different handling characteristics than the average car or truck.



### **Tires**

You must increase pressure in rear tires of tow vehicle to accommodate extra weight of tow dolly. When cold, inflate rear tires to approximately 6 pounds above their normal operating pressure, but DO NOT exceed pressure limit molded into tire sidewall. Normal pressure should be maintained in tow vehicle's front tires.

Tow dolly tires should be inflated to pressure recommended on operational decal on fender (45 or 50 psi). These are COLD pressures, and will increase when tires are hot from running. DO NOT bleed off this pressure increase. Incorrect tire pressure can adversely affect vehicle handling and gas mileage.



### **Mirrors**

State laws require vehicles towing a tow dolly to be equipped with mirrors on both sides. Inadequate side mirrors create a hazard by limiting rearward vision. If your vehicle is not already so equipped, you should put right and left hand full view, detachable mirrors on. Ask dealer if it has any available for rent if you do not want to purchase them.



## **Engine and Transmission Cooling**

Towing a loaded tow dolly can be quite demanding on engine and transmission cooling systems of tow vehicle, especially if towing long distance or in hilly terrain. Be sure your cooling system is in top shape, and adequate for towing anticipated load. Engine oil should be fresh and of maximum viscosity recommended for your particular engine. Engine cooling may be enhanced by flushing system and installing fresh coolant. Automatic transmissions may need an external oil cooler installed for unusually difficult or extended towing.

Engine and transmission heat increase as vehicle speed increases. To maintain proper cooling, do not exceed 55 m.p.h. regardless of engine size or load.



## **Hitch**

Be certain that hitch and hitch ball are securely attached and that hitch ball is 2" in diameter. A minimum rating of class II (3500 lbs) is required for both hitch and hitch ball.

Some sports utility vehicles are equipped with a bumper type hitch from the factory. **DO NOT USE THESE HITCHES**, since bumper may not have sufficient structural capacity to handle the load. Equip your vehicle with a hitch attached to the undercarriage of your vehicle.



## **Lights**

Lights are required on tow dollies in every state. If your vehicle is not already equipped for tow dolly light hook-up, it will be necessary to install connections now. Your dealer will let you know exactly what is needed for your particular vehicle.



## **Tow Vehicle Loading**

A loaded tow dolly tongue weight (approximately 200 lbs.) contributes to total cargo weight of tow vehicle. Tow vehicle manufacturer's recommended maximum passenger/cargo load must not be exceeded.



## **VEHICLE-IN-TOW**

Limitations/Cautions

1. Vehicle-in-tow must Not be wider than 76 inches at front doors to prevent damage to doors from contact with tow dolly fenders on turns.
2. Vehicle-in-tow must Weigh no more than 4,400 lbs.

Exceeding these limits may cause damage to tow dolly or vehicles.

Vehicle-in-tow tire tread must fit on ramps without overhanging sides. Track width (distance from left front tire center to right front tire center) must be between 49 and 59 inches.

Low hanging spoilers and air dams may be damaged by contact with tow dolly ramps when loading and unloading. Be sure there is adequate clearance for these. If not, they must be removed before loading.





### **Vehicle-in-Tow Facing Forward**

Vehicle-in-tow must always be facing forward (front wheels on tow dolly).



### **Transmission Damage to Towed Vehicles**

When towing a rear axle driven front engine vehicle, the drive shaft must be disconnected to prevent transmission damage. Simply placing transmission in neutral is not sufficient and will not prevent damage due to a lack of internal lubrication. You must disconnect drive shaft at rear axle and tie or wire it up. The universal joint bearing caps must be taped on to prevent loss of bearings. If you choose to remove drive shaft entirely, it may be necessary to cap transmission tail shaft to prevent fluid loss and possible future damage. Consult your vehicle owner's manual.

Front wheel drive vehicles need not have drive shafts disconnected because the drive wheels are loaded on tow dolly.

Towing damages many rear engine vehicle with transaxles. Consult owner's manual for tow suitability.



### **Passengers And Cargo Prohibited in the Vehicle-in-Tow**

Never transport any passengers or cargo in towed vehicle. In addition to being illegal in most states, carrying passengers in a towed vehicle exposes those passengers to risk of exhaust gas asphyxiation.



### **Lighting Requirements**

Even though tow dollies have operating lights, law requires that a vehicle-in-tow be equipped with functioning stop, turn and running lights. Detachable vehicle-in-tow towing lights can be purchased at many rental locations. They can also be purchased at auto supply shops. Follow instructions carefully when installing.



### **TOW DOLLY HOOK UP**

Double Check

After rental company has "hooked up" your tow dolly, it is wise for you to double-check connections both before and during trip.

**ALWAYS FOLLOW HOOK-UP, LOADING, AND UNLOADING INSTRUCTIONS ON FENDER DECALS OF TOW DOLLY. IF YOUR TOW DOLLY DOES NOT HAVE INSTRUCTIONS OR IF THEY ARE ILLEGIBLE, ASK COMPANY FOR A LEGIBLE COPY.**



## TOWING 55 Miles Per Hour

All vehicle combinations have a speed beyond which adequate emergency control cannot be assured. Maximum recommended speed for all tow dolly combinations is 55 m.p.h. **under good road conditions**. As road conditions deteriorate you must reduce the maximum recommended speed.

Posted speed limit is usually the same for trucks and car-trailer combinations. Observe this limit even if it is less than 55 m.p.h.

Please do not be lulled into a false sense of security because your tow dolly tows easily at higher speeds. A road hazard that would be avoidable at 55 m.p.h. can become unavoidable at 65 m.p.h.

If you drop any wheel(s) off the pavement, don't attempt any sharp steering corrections.

Remain off the pavement, decrease your speed until you have regained control, then drive slowly back onto pavement.



### Never Operate An Unstable Combination

Instability (swaying or whipping) of a tow vehicle/ tow dolly combination at low speeds usually increases at higher speeds. If combination begins to whip or sway, steer straight ahead, take your foot OFF the throttle, but **do not brake** until combination has stabilized. Stop in an off the road location and check tow vehicle and tow dolly as soon as possible.

- Review all instructions and be sure you have complied.
- Check that vehicle on tow dolly is loaded with front wheels on tow dolly. Reload if necessary.
- Check that all chains and tie down equipment remain tight and properly attached.
- Check for proper tire inflation all around combination.
- Make sure trunk or bed of towing and towed vehicles are not loaded with cargo.
- Check wheel bearings and lug nuts on both tow vehicle and tow dolly to be sure a wheel has not become loose.
- Check tow vehicle's wheel alignment.
- Finally, be sure you are not exceeding maximum recommended speed (55 MPH).

If you have followed preceding instructions, any instability should be corrected. If situation persists, stop and call for professional assistance from a tow truck operator.



## **BREAKDOWNS**

### Get Off The Road

Immediately park tow vehicle-tow dolly combination in a safe place completely off the highway. Get all occupants out of vehicle and away from roadway.

If you must continue on the highway to reach a safe place off the road, turn on emergency flashers and proceed with caution.

Do not hesitate to proceed on a flat tire if necessary to reach a safe place completely off the highway. Proceed slowly, for road friction could ignite a flat tire and cause a fire.



## **Rough Roads**

To prevent damage to tow vehicle or tow dolly, reduce speed when towing tow dolly over rough roads.



## **Turning**

Avoid U-turns. Avoid turning too sharply. Turning too sharply may cause side of vehicle-in-tow to come in contact with rear of dolly fender and cause damage to both vehicles.



## **“Pro” Driving Tips**

Accidents occur more frequently at night with a tired driver exceeding recommended speed on a downgrade, wet road, or curve. Don't attempt to drive “straight through.” Be rested. Slow down for down-grades, wet roads or curves. Night drivers have three times the fatality rate of day drivers. Avoid driving at night.



## **ACCIDENTS**

Move all vehicles completely off the road.

Get everyone out of the vehicle and off the road. Call police.

**Demco wants you  
to have a safe towing experience.**

**Read these instructions carefully,  
read fender decals on tow dolly,  
and follow all instructions.**

# BOLT TORQUE

## TORQUE DATA FOR STANDARD NUTS, BOLTS, AND CAPSCREWS.

Tighten all bolts to torques specified in chart unless otherwise noted. Check tightness of bolts periodically, using bolt chart as guide. Replace hardware with same grade bolt.

NOTE: Unless otherwise specified, high-strength Grade 5 hex bolts are used throughout assembly of equipment.

### Bolt Torque for Standard bolts \*



### Torque Specifications

Torque wheel nuts to 120 ft/lbs

"A"	GRADE 2		GRADE 5		GRADE 8	
	lb-ft	(N.m)	lb-ft	(N.m)	lb-ft	(N.m)
1/4"	6	(8)	9	(12)	12	(16)
5/16"	10	(13)	18	(25)	25	(35)
3/8"	20	(27)	30	(40)	45	(60)
7/16"	30	(40)	50	(70)	80	(110)
1/2"	45	(60)	75	(100)	115	(155)
9/16"	70	(95)	115	(155)	165	(220)
5/8"	95	(130)	150	(200)	225	(300)
3/4"	165	(225)	290	(390)	400	(540)
7/8"	170	(230)	420	(570)	650	(880)
1"	225	(300)	630	(850)	970	(1310)

### Bolt Torque for Metric bolts \*

"A"	CLASS 8.8		CLASS 9.8		CLASS 10.9	
	lb-ft	(N.m)	lb-ft	(N.m)	lb-ft	(N.m)
6	9	(13)	10	(14)	13	(17)
7	15	(21)	18	(24)	21	(29)
8	23	(31)	25	(34)	31	(42)
10	45	(61)	50	(68)	61	(83)
12	78	(106)	88	(118)	106	(144)
14	125	(169)	140	(189)	170	(230)
16	194	(263)	216	(293)	263	(357)
18	268	(363)	--	--	364	(493)
20	378	(513)	--	--	515	(689)
22	516	(699)	--	--	702	(952)
24	654	(886)	--	--	890	(1206)

Torque figures indicated are valid for non-greased or non-oiled threads and heads unless otherwise specified. Therefore, do not grease or oil bolts or capscrews unless otherwise specified in this manual. When using locking elements, increase torque values by 5%.

\* GRADE or CLASS value for bolts and capscrews are identified by their head markings.

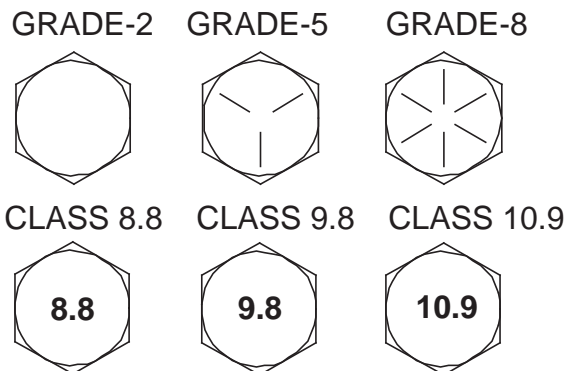
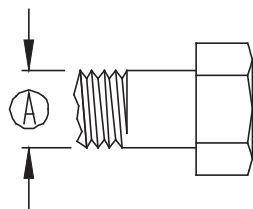

## Tongue and Ramp Assembly Instructions

1. Place the main frame (#1) on blocks or some other sturdy support so that the frame rests approximately 8" - 10" off the ground.
2. With an assistant, place tongue assembly (#2) into main frame channel and position latch on tongue approximately 3" from front of channel. Clamp tongue to main frame and support front of tongue.
3. Locate the four bullet connectors extending out the back of the tongue and plug into the connector protruding from under the main frame channel. Plug into the flat four connector by matching the colors. Do not cross colors when making this connection. Make sure that the two pigtails for the license plate bracket are out.
4. With an assistant, mount the tongue assembly (#2) to the front of the Kar Kaddy main frame and use a 5/8" x 4-1/2" grade 5 bolt (#3) and lock nut (#4) (torque to 50 ft. lbs). Do not torque over 50 ft. lbs. or bed will not tilt.  
**NOTE:** Brake line and wiring must be above bolt also coupler assembly must be ahead of bolt. Do this by opening tongue about half way.
5. Lay the bracing struts (#5) out along the tow dolly tongue with the back end (the end with the larger hole in it) of the bracing strut toward the main frame. Loosely bolt the back of each bracing strut to the trailer frame as shown using 1/2" x 1-1/2" grade 5 bolt (#6), flatwasher (#7), pivot bushing (#8) and locknut (#9). Hold up the front end (the end with the smaller hole) of each bracing strut to the tongue and secure with two 5/8" x 1-1/4" epoxied hex head bolts (#10). Torque the 1/2" x 1-1/2" bolt with the pivot bushing to 75 ft. lbs. Torque the two 5/8" x 1-1/4" epoxied hex head bolts to 100 ft. lbs.
6. Attach the tilt bed ramps (#11) as shown using four 1/2" x 1-1/4" grade 5 bolts (#12), flat washer (#7) and lock nuts (#9), two on each side of each ramp, and then three 7/16" x 1" grade 8 bolts (#13) and lock nuts (#14) on the top of each ramp. Torque 7/16" bolts to 80 ft. lbs. and torque 1/2" bolts to 75 ft. lbs.
7. Attach rear tire stop (#15) as shown using two 3/8" x 1-1/4" grade 5 bolts (#16), flat washers (#17) and lock nuts (#18). These 3/8" x 1-1/4" bolts will also go through the tilt bed ramps. Torque 3/8" x 1-1/4" bolts to 35 ft. lbs.
8. Repeat steps 6-7 for other side.

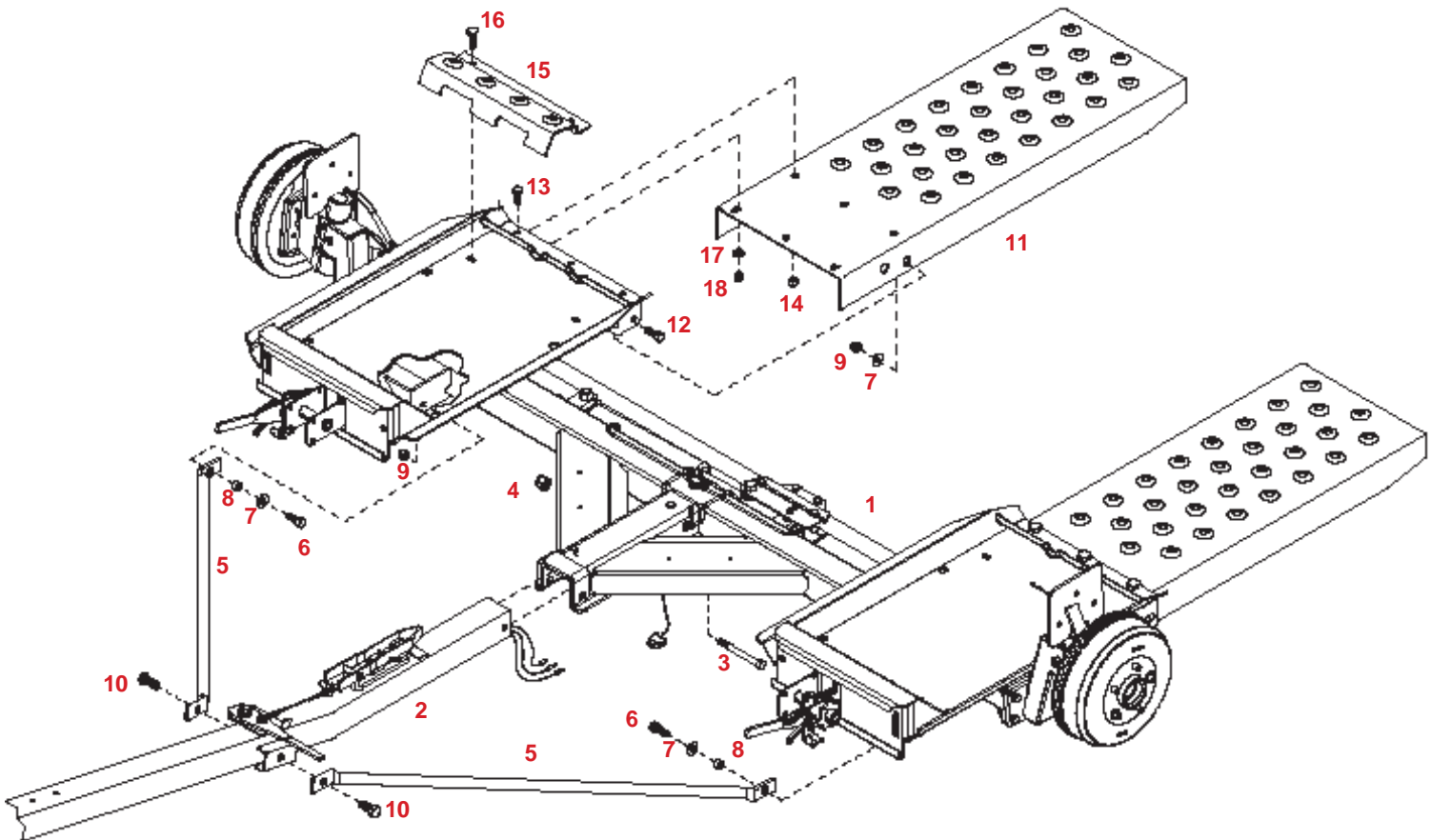

## Fender Assembly Instructions

1. Install fender with fender backup plate (#1) and three 3/8" x 1-1/2" bolts (#2). Put 3/8" nylon lock nuts (#3) inside of fender and tighten.

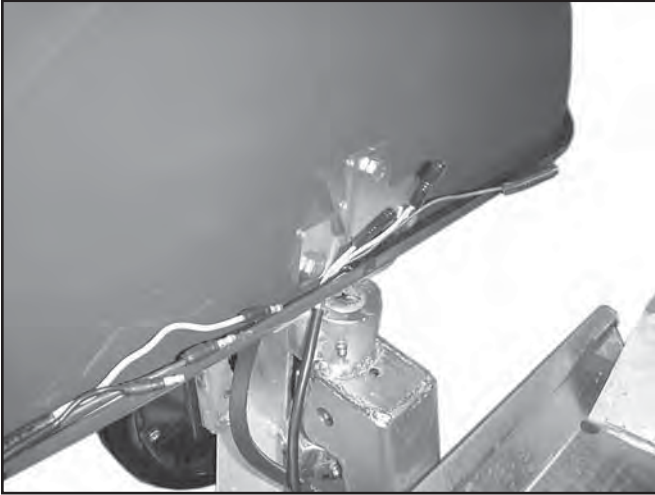

2. Cut nylon wire tie from wiring to brake hose on main frame, (used for shipping purposes only). Fish the three wires from main unit through the hole in fender.

3. On the left side, plug in bullet plugs with white to white, black to brown and yellow to red. On the right side, plug white to white, black to brown and green to red.

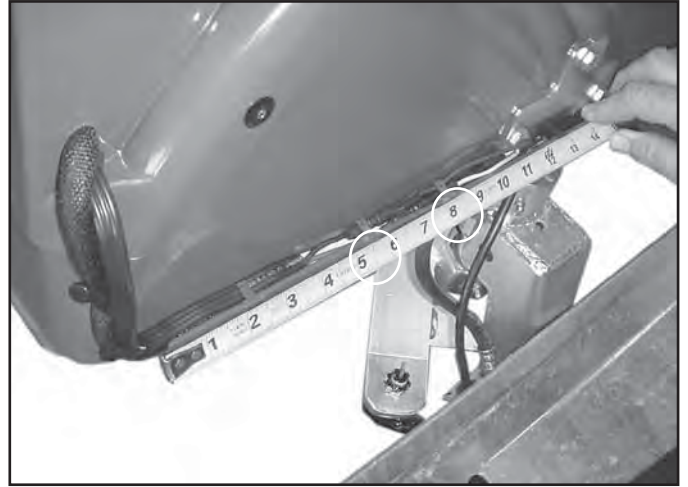

4. With a pliers, install two wire clamps on fender. From rear of fender lip, install one clamp at 5-1/2" and one at 8".
5. Mount the mud flaps (#4) to the inside back of the fender using two 1/4" x 3/4" truss head bolts (#5) with flat washers (#6) and lock nuts (#7). Make sure the Kar Kaddy logo on the flap faces the rear.

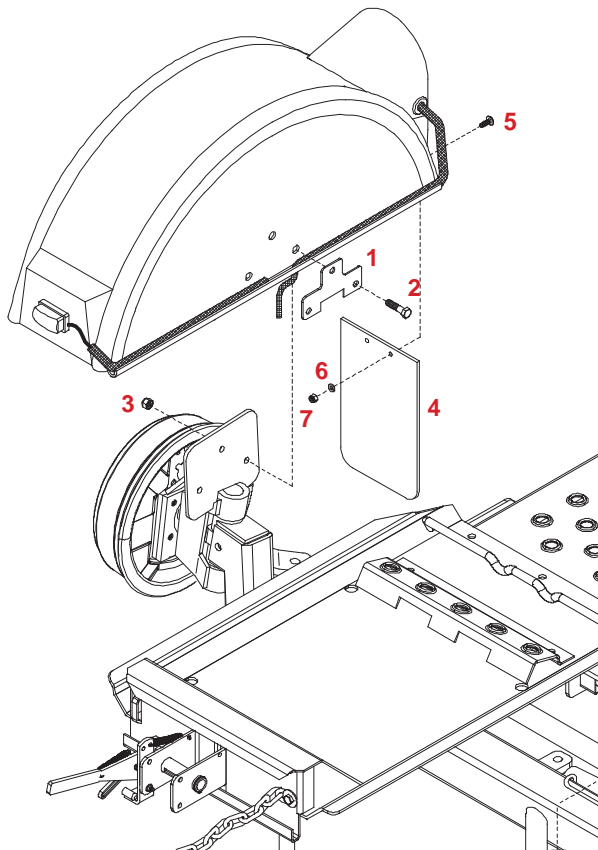



**⚠ WARNING: FAILURE TO FOLLOW THESE INSTRUCTIONS CAN RESULT IN LOSS OF TOWING VEHICLE CONTROL, SEPERATION OF THE TOW DOLLY FROM THE TOWING VEHICLE, SEPERATION OF THE TOWED VEHICLE FROM THE TOW DOLLY, CAUSING SEVERE PERSONAL INJURY, DEATH, OR PROPERTY DAMAGE.**

### **⚠ SAFETY**

Safety is of utmost importance at all times. There are several items that must be checked each time before using and while using the Kar Kaddy.

Make sure all bolts are properly tightened and those requiring a set torque are up to specifications:

Tie Rod Castle Nut - 75 ft./lbs.

Lug Nuts - 120 ft./lbs.

Check Lug Nut tension after the first 5 miles and periodically thereafter.

The ball hitch must latch securely around the ball and the safety lock pin or lever must be in position to lock the hitch on the ball.

**RECOMMENDED BALL HEIGHT: 18 inches to the top of the ball on the towing vehicle.**

Hook the towed vehicle safety chains to the frame of the vehicle directly above the area where the chain is mounted on the Kar Kaddy. Leave some slack in the chain to allow suspension movement.

Check to make sure that all lights are in proper working order.

Examine the winches and straps, making sure they are in good condition.

Be certain the safety lock pins are locking the strap winches.

Retighten straps over the tires after the first 5 miles and every 50 miles thereafter. Ensure that they are tight.

The tires must be inflated to the recommended 50 PSI.

The strap on the optional tongue winch must be in good condition and should be stored neatly on winch when not in use.

**NOTE:** The winch strap must not be left connected to the towed vehicle after it is loaded and strapped down.

Make sure the optional light bar is fastened securely at the rear of the towed vehicle.

The wires to the optional light bar should be run along the car and fastened so as not to damage the finish of the towed vehicle.

**NOTE:** This unit cannot be backed up, when loaded or with the steering lock pin removed.

All vehicles mounted on the Kar Kaddy must be mounted with the front of the vehicle facing forward.

**Rear Wheel Drive:** Disconnect the towed vehicle driveshaft for rear wheel drive vehicles with automatic transmission.

**For manual transmission:** Consult your vehicle owners manual for towing suitability with the drive shaft connected.

### **MAINTENANCE**

Periodically check all bolts and nuts to insure proper tension or torque.

**Grease the king pin and tie rod end grease zerks every 2500 miles.**

An occasional drop of oil may be required on the moving parts of the tie down winches.

A light film of oil should periodically be applied to steering stabilizer arm to prevent rust.

**NOTE: Proper toe-in is 1/32". This is preset at the factory.**

The operator should periodically have the toe-in checked and adjusted if needed at a qualified alignment shop. Improper toe-in can result in irregular tire wear.

### **IMPORTANT LOADING INSTRUCTION**

**Check your wheel tie-down straps.**

Your Kar Kaddy is equipped with custom made wheel tie-down straps of a standard size that will fit most tires, however if your tires are too large or too small you will want to exchange these new straps for the proper size straps.

- 1. Tire too large** - This is very obvious the strap will not basket over the tire properly, call us, we will provide at NO Charge on an exchange basis, the proper size strap. You must return your new unused straps and provide us with the Make and Model car and the tire size.
- 2. Tire too small** - This is not as obvious, the basket will fit down over the tire very well, the problems cannot be readily seen. You must tighten the straps down solid and then check on the inside of the tire and be sure the strap, when tightened does not come in contact with any metal that may cause wear or cutting such as strut mounts. If there is contact, you need a smaller strap, call us, we will provide on a NO Charge, exchange basis, the proper size strap. You must return your new unused straps and provide us with the Make and Model car and tire size.

Thank you for Purchasing **Demco** Products.

## **Loading Angle Clearance Guide**

**NOTE: User's responsibility for checking clearance**

### **IMPORTANT:**

Using this guideline will reduce the chance of the towed vehicles air dam, or bottom of fascia from interfering with tow dolly platform and or tire stop. "X" must be less than 3-1/2 x "Y".

Example: If Y measures 6"  
 $3\text{-}1/2 \times 6 = 21$   
X must measure less than 21"

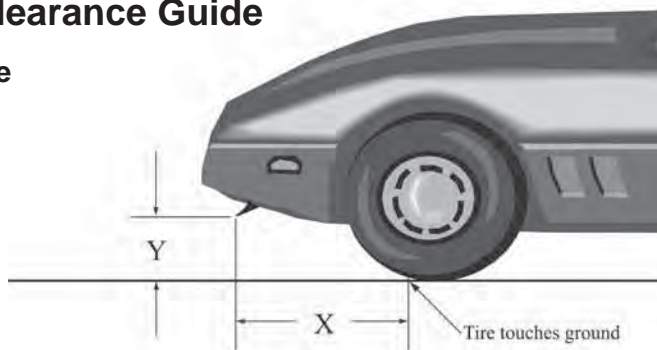

## LOADING INSTRUCTIONS

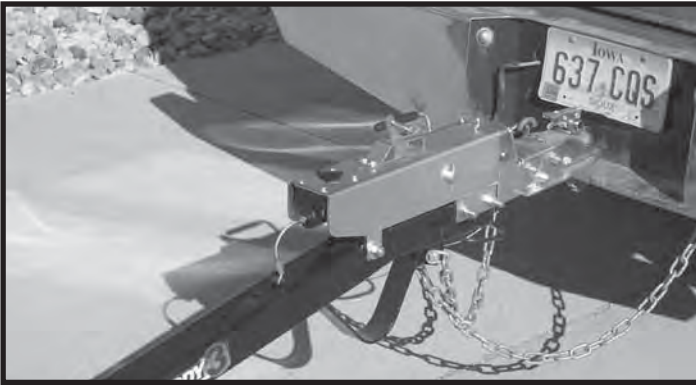

**Step 1.** Secure ball coupler to 2" (6,000 lb. capacity) towing vehicle ball only. Make sure that the hitch and the hitch ball are in good condition and not rusted, loose or stripped. **Recommended ball height is 18" to the top of the ball.** Make sure hitch is locked down and secured with safety clip. Criss-cross safety chains under tongue and secure to towing vehicle frame.



**Step 4.** Before loading (and unloading) towed vehicle make sure platform and towed vehicle are in straight alignment. Tow dolly must be completely and properly hooked up to the towing vehicle. **Towing vehicle must be larger and at least 1000 lbs. heavier than the tow dolly and towed vehicle combined.**

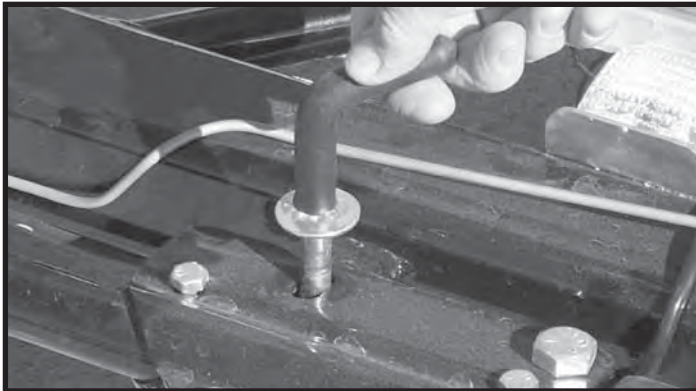

**Step 2.** Remove black locking pin **BEFORE** loading vehicle onto the Kar Kaddy. The removal of the locking pin allows "Auto Steer" to operate. When towing the dolly empty, this pin must be in place.

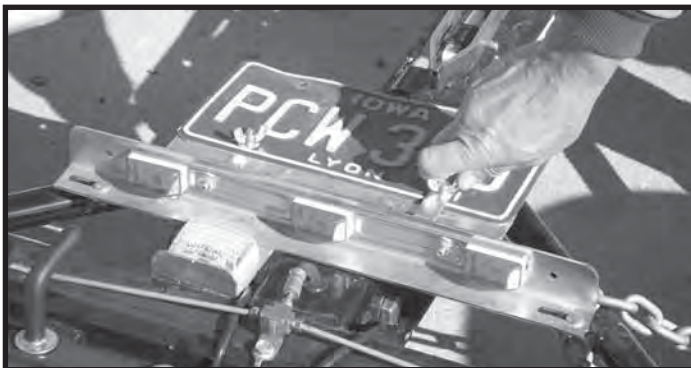
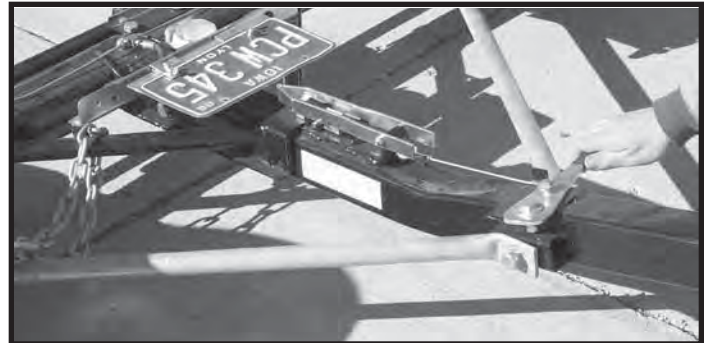

**Step 3.** Loosen wing nut on back of license plate holder, turn the clip on the front to a horizontal position and put license in the "down" position. Turn the clip back so it rests against the back of the light bar to hold the license down and tighten wing nut.

**(License must be "UP" with the tow dolly empty).**

**IMPORTANT:** Tire tread width or body width of towed vehicle must not exceed:

76" max. (outside to outside),  
42" min. (inside to inside),  
76" max. (body width).

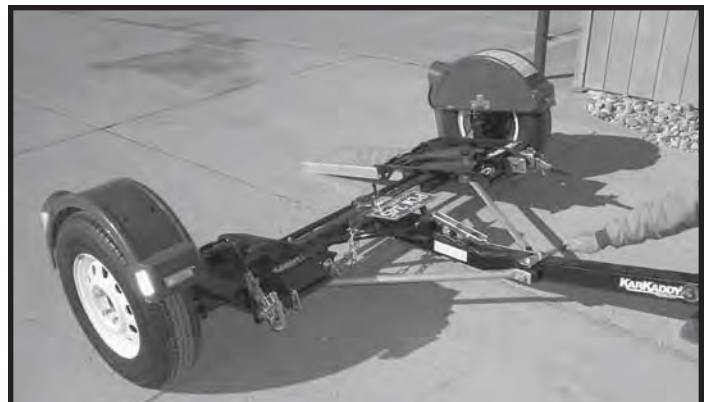

**Step 5.** Grasp bed release handle on tongue and pull toward coupler. This releases the tilt bed to permit loading.





**Step 6.** With someone safely guiding you, slowly drive vehicle onto platform **FRONT FORWARD**. (Any vehicle mounted on tow dolly must be mounted with front of the vehicle facing forward.) Drive the car forward until the tires touch the ramps. Make sure the tire is aligned to ascend onto the ramps.



**Step 7.** Drive vehicle onto the platform - **front forward** - until tires touch the wheel stops at the front of each side of the platform and the platform tilts to a flat position. Make sure the car is centered on the platform. Towed vehicle tires must fit in wheel troughs without overhanging sides. Engage towed vehicle parking brake. Shift loaded car into "park" and lock steering wheel with front tires in a straight position. If the car does not have a locking steering column the steering wheel must be tied securely with front tires in a straight position.

**Rear Wheel Drive:** Disconnect towed vehicle driveshaft for rear wheel drive vehicles with automatic transmission.

**For manual transmission:** Consult your vehicle owners manual for towing suitability with the drive shaft connected.

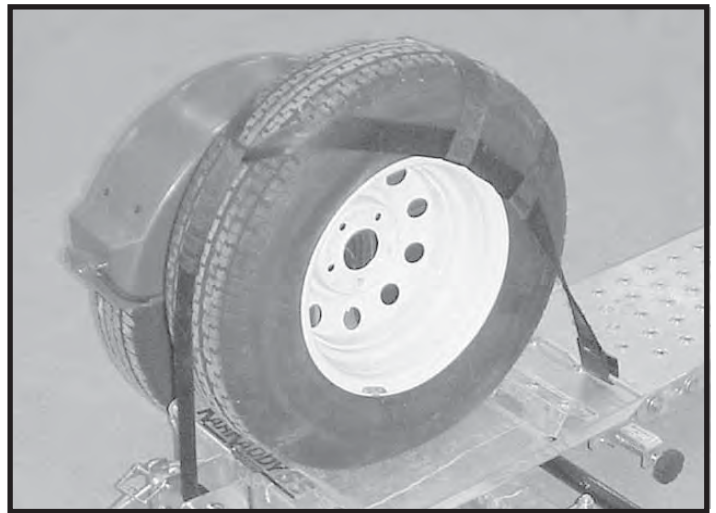

**Step 8.** Place one tie-down strap over each tire and secure hooks to rods located at the rear of each wheel platform. The short side of the hook must face the rear of the Kar Kaddy.

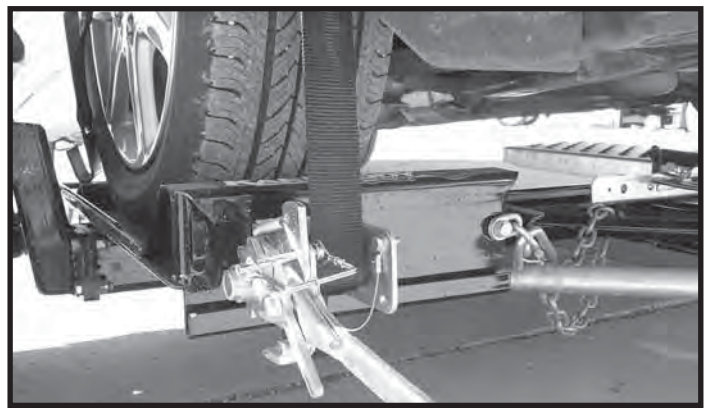

**Step 9.** Be sure tie-down winch is centered with the tire before tightening straps.

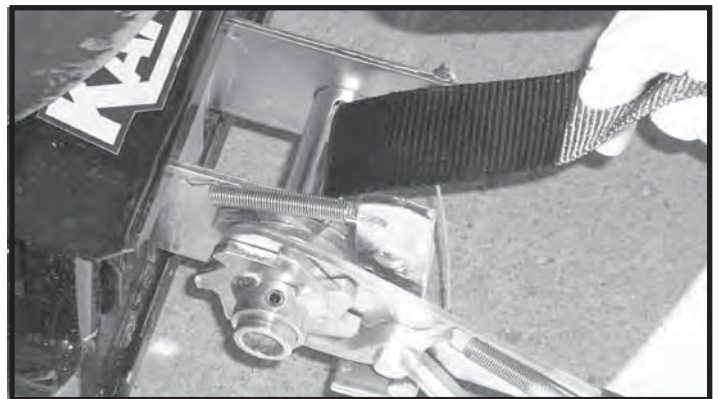

**Step 10.** Thread tie-down strap through the slotted tube on the tie-down winch. Pull approx. 6" of strap through this slot. Begin tightening strap making sure the tail becomes enclosed by the strap coming over the tire. Tighten the straps ensuring that the strap fed through the slot binds between the shaft and the strap being wound onto the winch shaft. While tightening straps, pull cross strap forward to ensure even tightening. **NOTE: Be sure to tighten straps until each tire starts to flatten against tire stop.** After each strap is tight, insert a safety pin in each winch. Disengage towed vehicle parking brake.

**Straps must be retightened after first 5 miles of travel. Check straps every 50 miles thereafter to ensure they are tight and not rubbing or fraying.**

**Step 11.** Make sure the tie-down strap is the correct size for the auto tire. See page 11 of this instruction for proper fit and exchange instructions.

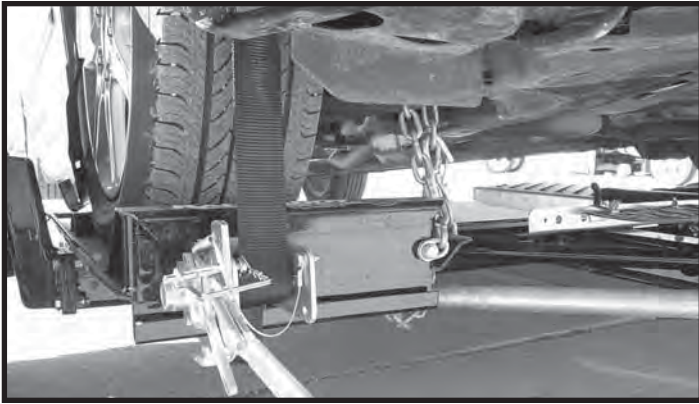

**Step 12.** Hook the towed vehicle safety chains to frame of vehicle directly above the area where the chains are mounted on the Kar Kaddy. Leave some slack in the chains to allow suspension movement of the towed vehicle.

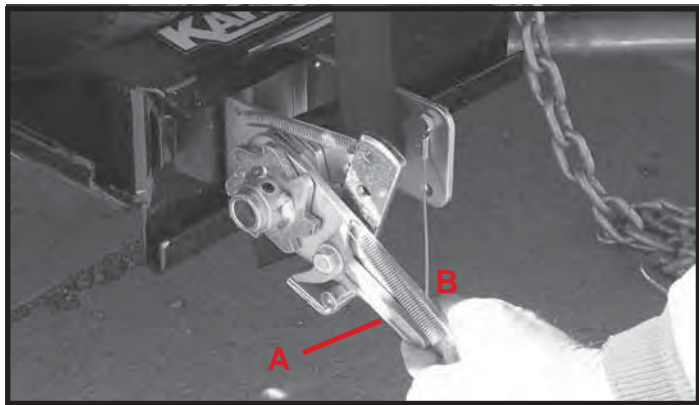

**Step 13.** TO UNLOAD towed vehicle. Make sure that platform and vehicle are straight. Reinstall driveshaft. Ensure that towed vehicle parking brake is fully engaged, then unhook the towed vehicle safety chains, and release the tie-down straps. **NOTE:** Tie down straps must be “quick -released” by grasping ratchet pawl (A) and ratchet handle (B) simultaneously and pushing down sharply. This process will permit easy removal of strap from winch. Swing the wheel platform locking latch handle forward, towards the coupler. This will allow the platform to tilt as you slowly drive off. Make sure the winch ratchet handles are horizontal. Replace the “Auto Steer” locking pin (for towing empty).

**Step 14.** To pull the Kar Kaddy empty, make sure “Auto-Steer” LOCKING PIN IS IN PLACE and towing vehicle safety chains are up and hooked. Tie-down winch handles should be left in a down position (horizontal) position with safety pins in place when towing loaded or empty. **DO NOT ATTEMPT TO PULL KAR KADDY WITH WHEEL PLATFORM IN LOADING (tilted) POSITION.**

### DAMAGE PREVENTION

Check your vehicle manual or registration for vehicle weight. Towing vehicle must be larger and at least 1,000 lbs. heavier than the towed vehicle and tow dolly combined.

Do not pack goods in car that is being towed. Overloading the Kar Kaddy or exceeding the width limit may result in damage to both car and Kar Kaddy.

### REAR WHEEL DRIVE PRECAUTIONS

Disconnect towed vehicle driveshaft for rear wheel drive vehicles with automatic transmission. Simply placing transmission in neutral is not sufficient to prevent damage to transmission.

For manual transmission: Consult your vehicle owners manual for towing suitability with the drive shaft connected.

**ALL VEHICLES MOUNTED ON THE KAR KADDY MUST BE WITH THE FRONT OF THE VEHICLE FACING FORWARD.**

## CAUTION

- Examine winches and straps to make sure they are in good condition.
- Check wheel nuts every trip.
- Tires must be inflated to recommended pressure by tire manufacturer.
- Be certain the safety lock pins lock the strap winches.
- Retighten the straps over the tires after the first 5 miles of travel. Check straps every 50 miles thereafter to ensure they are tight and not rubbing or fraying.