

OPERATING INSTRUCTIONS

QUIK DRIVE[®] PRO Series

SIMPSON
Strong-Tie[™]

Attachments: QDPR051E, QDPR064E, QDPROPHE, QDHSD60E, QDHSD75E
Systems: QDPR051KE, QDPR064KE

SAVE THESE INSTRUCTIONS

QUICK START INSTRUCTIONS Complete instructions inside

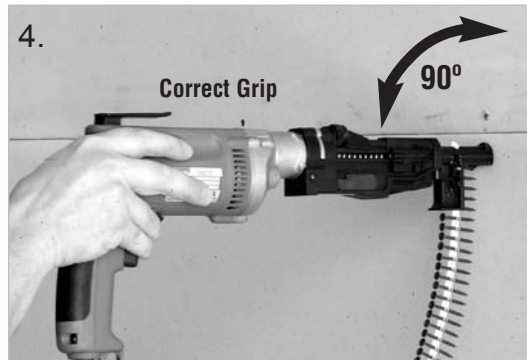

DRIVING SCREWS

Be sure screwgun is in FORWARD.

Start screwgun before applying pressure.

Apply pressure to keep bit engaged until screw is fully driven and clutch releases.

Keep screwgun running between screws.



+ 44 1827 255 600
www.strongtie.co.uk

+ 33 (0) 251 28 44 00
www.simpson.fr

+ 49 4242 959 412
www.simpsonstrongtie.de

PARTS - SCHEMATIC - COMPONENTS

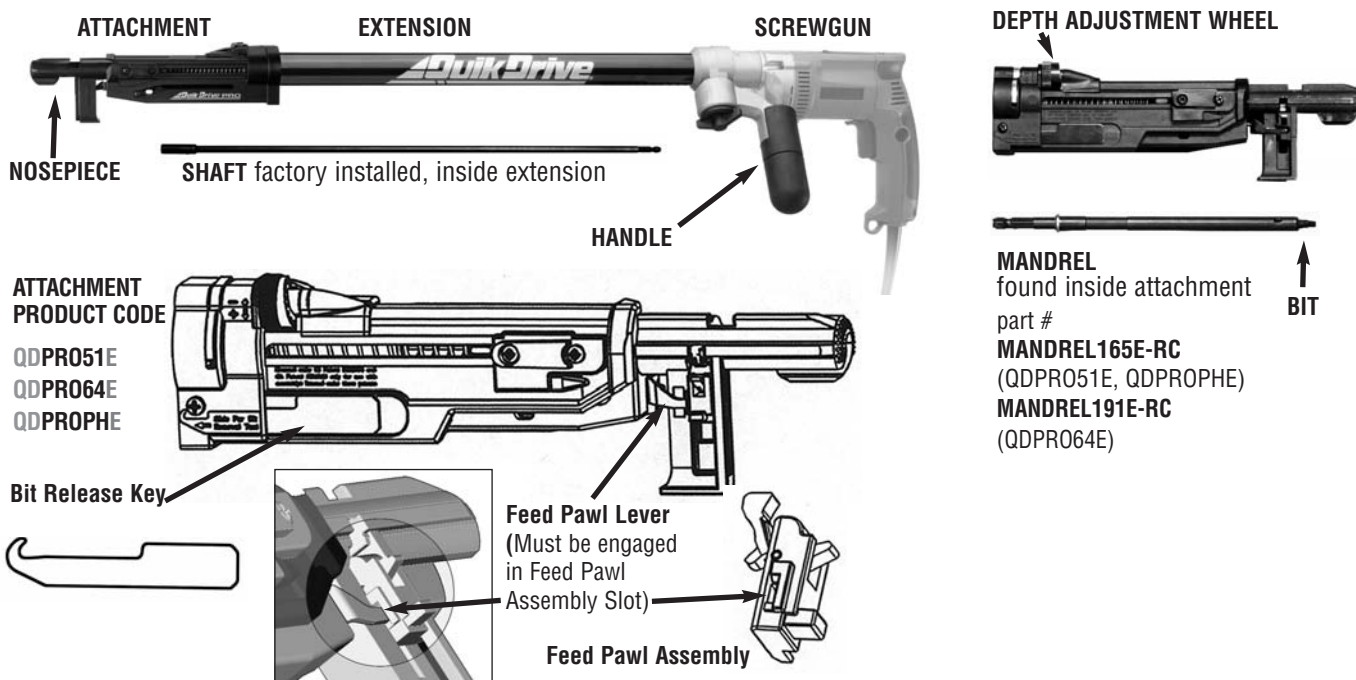

Using the correct driving bit is necessary.

The free bit(s) included in each box of Quik Drive® screws should drive the entire box. Variations in materials and driving technique can cause excessive wear so additional bit packs are available for purchase. Reference the description on the bit sticker in your box of screws or the screw box label to ensure correct selection.

Bit pack product codes:

- BIT2SE-RC3** - #2 square drive, for most screws with #2 recess and interior grade coating
- BIT2SUE-RC3** - #2U (*Undersized*), for most screws with #2 recess and exterior grade coating
- BIT3SE-RC3** - #3 square drive, for most screws with #3 recess and interior grade coating
- BIT3SUE-RC3** - #3U (*Undersized*), for most screws with #3 recess and exterior grade coating
- BIT2PE-RC3** - #2 phillips for all Quik Drive® screws with phillips recess

TROUBLESHOOTING GUIDE

Quik Drive tools are easy to use. As with any power tool, there are a few basic things to remember.

PROBLEM	SOLUTION
Screws won't drive. They spin for a second, then lay over on their side. Little or no penetration.	<i>Make sure the screwgun is not in reverse.</i>
Screws won't drive completely. They go down about halfway, then the bit spins out.	<i>Check to be sure you are using the correct bit for the type of screws you are driving. Check for bit wear. It may be time to install a new bit. Push harder when driving</i>
Screws won't drive completely. They are almost completely driven but won't countersink completely.	<i>Check the depth adjustment on the attachment. Reset if necessary. You may have missed the substrate. Example: In flooring, this will occur if you miss the joist.</i>
Screws don't advance properly causing tool to jam.	<i>Use only genuine Quik Drive® brand collated screws. Be sure the screw strip is inserted correctly - pointed end first. Lift the tool completely off the work surface after driving each screw. Don't drag screw strips on the work surface as you move to the next position. Be sure the feed pawl assembly is intact and feed lever is engaged.</i>

OPERATING INSTRUCTIONS

ATTACH ADAPTOR TO YOUR SCREWGUN (If you purchased a complete system with screwgun; skip this step)

Remove nose-cone and bit holder from your screwgun according to manufacturer's directions (most will pull straight off).

Replace with Quik Drive adaptor made for the screwgun. Follow specific instructions included with Quik Drive adaptor.



INSTALL CORRECT BIT

Be sure you have the correct bit for the screws you are driving. It's a good practice to install one of the free bits included with our screws when you open a new box.

Remove the attachment and pull the mandrel from the unit. Extend the bit release key and pry the bit out.

Put a new bit in place and push against a solid surface until it snaps in place.

Insert end of bit release key into slot and pry bit out



CONNECT ATTACHMENT TO SCREWGUN OR EXTENSION

Insert mandrel in extension or screwgun, slide attachment on and push tight - until the locking lever snaps in place.

You can turn the attachment any way that is comfortable.

New tools may be tight and hard to lock in place. If so, just put the nose against a solid surface and push down sharply (see photo at far right).



Seat mandrel first, then add attachment

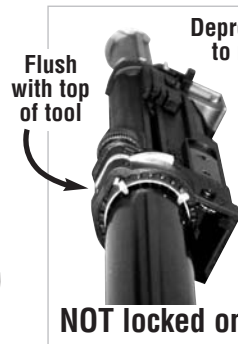

Check locking lever position to be sure attachment is locked on
To remove, unlock and pull

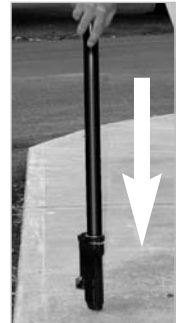

If new tool is hard to lock on, place nose on solid surface and push down

ATTACH EXTENSION TO SCREWGUN

Turn the clamping handle in the "off" direction (clockwise) until the internal clamp is out of the way. Insert the screwgun, with G2 Adaptor in place, into the end of the extension. Push tight and tighten clamping handle. If it won't fully insert, start the screwgun slightly until the drives mesh.

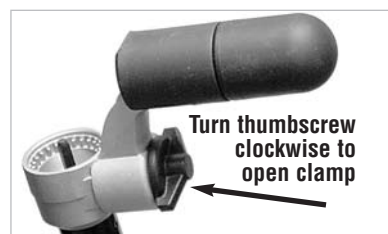

Turn thumbscrew clockwise to open clamp

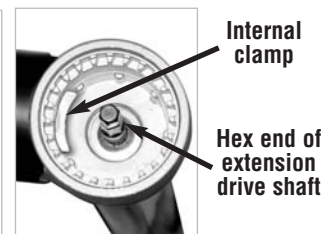

Internal clamp

Hex end of extension drive shaft



Pointed end first



Screw release lever (silver) - push down to unload

LOAD SCREWS

Insert a screw strip pointed end first, until they click in place. Push release lever to unload.

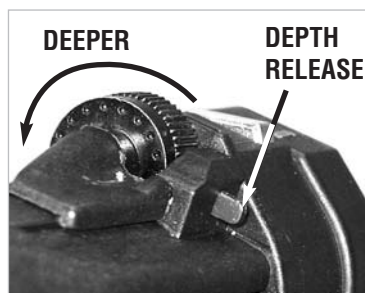

DEEPER

DEPTH RELEASE

SET DEPTH

Press DEPTH RELEASE to adjust. Test in scrap material.

ADJUST HANDLE HEIGHT



READ AND FOLLOW ALL INSTRUCTIONS
WHEN SERVICING USE ONLY IDENTICAL QUIK DRIVE® REPLACEMENT PARTS.
ATTENTION - Please see screwgun manufacturer's instructions for safe use of electric power tools.



44 1827 255 600
www.strongtie.co.uk

33 (0) 251 28 44 00
www.simpson.fr

49 4242 959 412
www.simpsonstrongtie.de